

Areas of Landslides

New Rockford Quadrangle, North Dakota

Christopher A. Maike

2023

Areas of landslides were investigated within this quadrangle based on a review of county historical aerial photography flown in 1964 by the United States Department of Agriculture (USDA). Additional data sources include digital orthophotography from the USDA National Agriculture Imagery Program (NAIP) flown in September 2021 and the North Dakota Geological Survey LiDAR Map Series, which compiles raw data flown in April 2021 from the North Dakota State Water Commission. From this investigation, no landslides were mapped within the quadrangle.

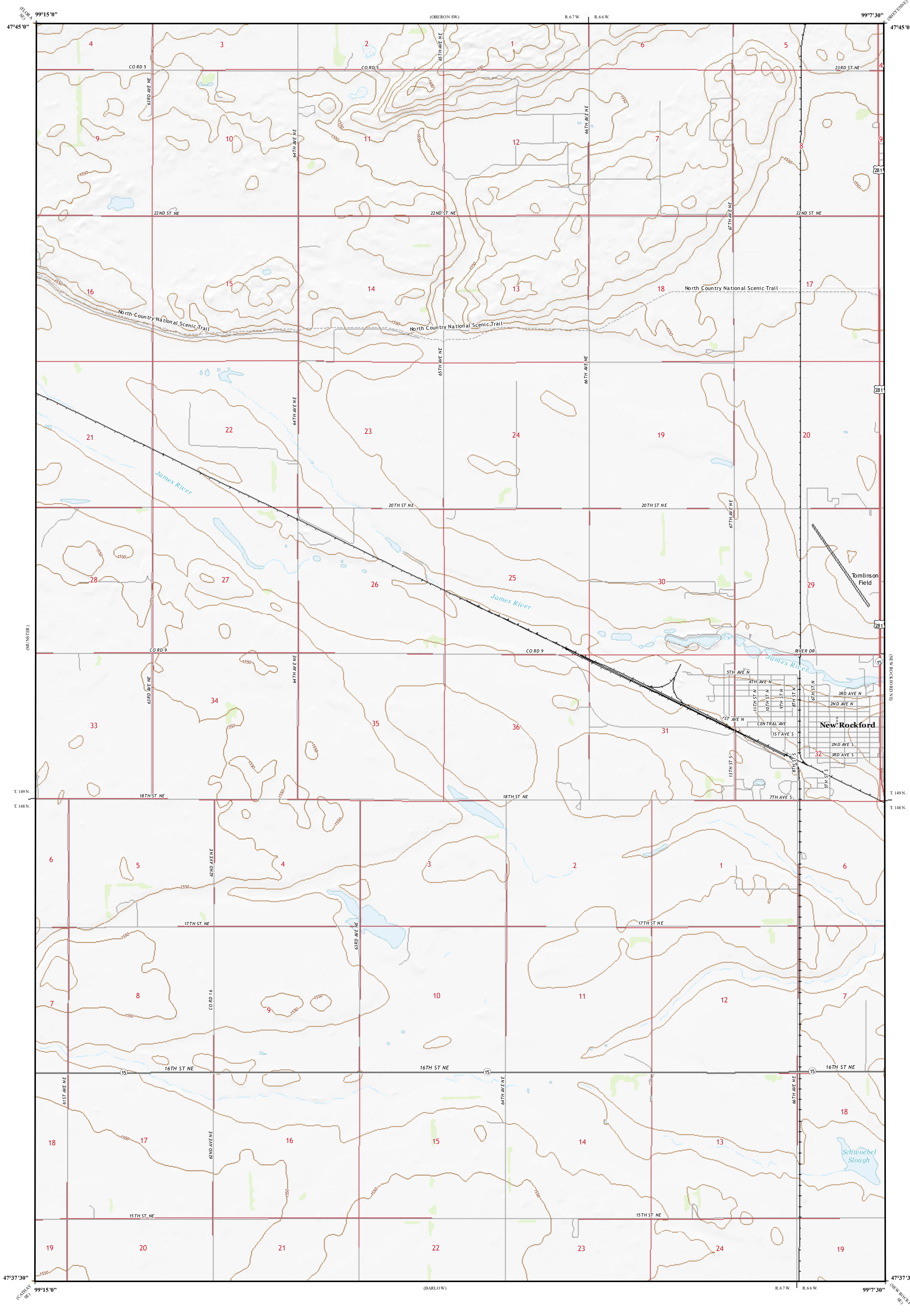

ROAD CLASSIFICATION

- Expressway
- Secondary Hwy
- Ramp
- Local Connector
- Local Road
- 4WD
- Interstate Route
- US Route
- State Route

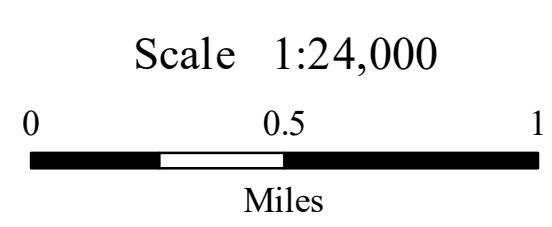
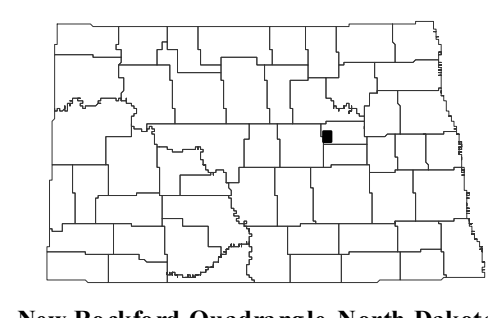
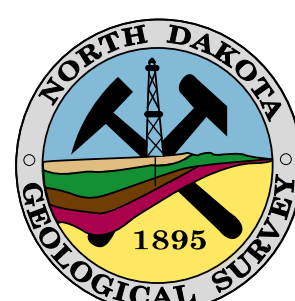

Lambert Conformal Conic Projection
North American 1983 Datum
USGS 7.5 Minute Topo Map

Standard Parallels: 47°37'30"N, 47°45'0"N
NGVD 1988
Contour Interval 10 Feet

