

BEFORE THE INDUSTRIAL COMMISSION
OF THE STATE OF NORTH DAKOTA

CASE NO. 8987
ORDER NO. 10557

IN THE MATTER OF A HEARING CALLED ON A MOTION OF THE COMMISSION TO CONSIDER THE APPLICATION OF CONTINENTAL RESOURCES, INC. FOR AN ORDER EXTENDING THE FIELD BOUNDARIES AND AMENDING THE FIELD RULES FOR THE SADLER-BAKKEN POOL SO AS TO CREATE AND ESTABLISH TWO 1280-ACRE SPACING UNITS COMPRISED OF ALL OF SECTIONS 2 AND 11 AND SECTIONS 14 AND 23, T.161N., R.95W., DIVIDE COUNTY, NORTH DAKOTA, AUTHORIZING THE DRILLING OF ONE HORIZONTAL WELL ON EACH SPACING UNIT, AND/OR SUCH OTHER AND FURTHER RELIEF AS THE COMMISSION DEEMS APPROPRIATE.

ORDER OF THE COMMISSION

THE COMMISSION FINDS:

- (1) This cause came on for hearing at 9:00 a.m. on the 25th day of May, 2006.
- (2) The witnesses for Continental Resources, Inc. (Continental) provided telephonic testimony in this matter, pursuant to North Dakota Administrative Code (NDAC) Section 43-02-03-88.2. Telephonic Communication Affidavits were received on June 7, 2006, therefore, such testimony may be considered evidence.
- (3) Continental made application to the Commission for an order extending the field boundaries and amending the field rules for the Sadler-Bakken Pool so as to create and establish two 1280-acre spacing units comprised of all of Sections 2 and 11 and Sections 14 and 23, Township 161 North, Range 95 West, Divide County, North Dakota (Sections 2, 11, 14, and 23), authorizing the drilling of one horizontal well on each spacing unit, and/or such other and further relief as the Commission deems appropriate.
- (4) Order No. 10123 entered in Case No. 8623 established proper spacing for the development of Zone I in the Sadler-Bakken Pool at one well per 160 acres, Zone II at one horizontal well per 640 acres, and Zone III at one horizontal well per 1280 acres.

(5) Sections 11, 14, and 23 are within the buffer zone of Zone I in the Sadler-Bakken Pool. Section 2 is one section removed from the buffer zone of Zone I in the Sadler-Bakken Pool.

(6) Continental presented evidence that the Sadler-Bakken Pool underlies Sections 2, 11, 14, and 23; therefore, the boundary of the Sadler Field should be extended to include such lands.

(7) There are no wells currently permitted to or producing from the Sadler-Bakken Pool in Sections 2, 11, 14, or 23.

(8) Continental plans to develop the Bakken Pool under Sections 2 and 11 by drilling a dual-lateral horizontal well from a surface location approximately 150 feet from the north line and 300 feet from the west line of Section 11. The casing will be set horizontally in the Bakken Pool northeast of the surface location at a legal location and the first lateral will then be drilled to a bottom hole location approximately 660 feet from the north line and 2280 feet from the east line of Section 2. The second lateral will be drilled by cutting a window in the casing within the Bakken Pool at a legal location and drilling horizontally within the Bakken Pool to a bottom hole location approximately 660 feet from the south line and 2280 feet from the east line of Section 11. Continental plans to develop the Bakken Pool under Sections 14 and 23 by drilling a dual-lateral horizontal well from a surface location approximately 150 feet from the north line and 300 feet from the west line of Section 23. The casing will be set horizontally in the Bakken Pool northeast of the surface location at a legal location and the first lateral will then be drilled to a bottom hole location approximately 660 feet from the north line and 2280 feet from the east line of Section 14. The second lateral will be drilled by cutting a window in the casing within the Bakken Pool at a legal location and drilling horizontally within the Bakken Pool to a bottom hole location approximately 660 feet from the south line and 2280 feet from the east line of Section 23. Utilization of horizontal drilling technology in this manner may result in the wells being completed at a location or locations not in compliance with current applicable spacing orders for the Sadler-Bakken Pool.

(9) Evidence and testimony presented to the Commission indicates that the proposed horizontal wells will produce oil that might otherwise not be produced.

(10) Flexibility with respect to spacing unit size and the location of wells in the Sadler-Bakken Pool is essential to efficiently produce as much recoverable oil and gas as economically possible.

(11) Pursuant to Section 38-08-07 of the North Dakota Century Code, spacing units must be of uniform size and shape for the entire pool, except when found necessary to prevent waste, avoid the drilling of unnecessary wells, or to protect correlative rights, the Commission is authorized to divide any pool into zones and establish spacing units for each zone, which units may differ in size and shape from those established in any other zone.

(12) Zones of different spacing within the Sadler-Bakken Pool will allow the flexibility needed for utilization of horizontal drilling.

(13) Granting maximum flexibility in spacing unit size and in locating and drilling horizontal wells will result in economic and efficient development of the oil and gas resources in a manner that prevents waste and protects correlative rights.

(14) If Continental's activities are successful, greater ultimate recovery of oil and gas from the pool will be achieved which will prevent waste and the drilling of unnecessary wells in a manner which will not have a detrimental effect on correlative rights.

(15) There were no objections to this application.

(16) Approval of this application will prevent waste, avoid the drilling of unnecessary wells, and protect correlative rights.

IT IS THEREFORE ORDERED:

(1) Sections 2 and 11 and Sections 14 and 23, Township 161 North, Range 95 West, Divide County, North Dakota, are hereby established as 1280-acre spacing units for the exclusive purpose of drilling a horizontal well within each said spacing unit within the Sadler-Bakken Pool and Zone III is hereby extended to include said spacing units. Existing and future vertical and directional wells drilled within the spacing units herein established shall conform to the applicable spacing requirements providing for the orderly development of Zone I in the Sadler-Bakken Pool.

(2) The Director is hereby authorized to exercise continuing jurisdiction in this matter to determine whether a horizontal well proposed or drilled upon the 1280-acre spacing units herein established has justified the creation of such units, to require amendments or modifications to the permit to drill for such horizontal well, and to deny a permit to drill in the event a well is proposed to be drilled in a manner inconsistent with the evidence that justified such spacing unit.

(3) The Sadler Field is hereby redefined as the following described tracts of land in Divide County, North Dakota:

TOWNSHIP 161 NORTH, RANGE 95 WEST, 5TH PM

ALL OF SECTIONS 2, 11, 14, 15, 16, 17, 21, 22 AND 23, THE SW/4 OF SECTION 4, THE SE/4 OF SECTION 5, THE S/2 OF SECTION 8, THE S/2 AND NW/4 OF SECTION 9, AND THE N/2 OF SECTION 20,

together with those additional quarter sections or governmental lots corresponding thereto as may be proven productive by wells drilled on lands within one mile of the boundaries of the field as set forth above, provided further that such extensions of the field boundaries shall include only sufficient acreage to form a spacing unit for such wells, and any intervening lands.

(4) The Sadler-Bakken Pool is hereby redefined as the following described tracts of land in Divide County, North Dakota:

ZONE I

TOWNSHIP 161 NORTH, RANGE 95 WEST, 5TH PM

ALL OF SECTIONS 2, 11, 14, 15, 16, 17, 21, 22 AND 23, THE SW/4 OF SECTION 4, THE SE/4 OF SECTION 5, THE S/2 OF SECTION 8, THE S/2 AND NW/4 OF SECTION 9, AND THE N/2 OF SECTION 20,

together with those additional quarter sections or governmental lots corresponding thereto as may be proven productive by wells drilled on lands within one mile of the boundaries of the field as set forth above, provided further that such extensions of the field boundaries shall include only sufficient acreage to form a spacing unit for such wells, and any intervening lands.

ZONE II (Exclusively for horizontal wells)

TOWNSHIP 161 NORTH, RANGE 95 WEST, 5TH PM

ALL OF SECTION 17.

ZONE III (Exclusively for horizontal wells)

TOWNSHIP 161 NORTH, RANGE 95 WEST, 5TH PM

ALL OF SECTIONS 2, 11, 14, 15, 16, 21, 22 AND 23.

(5) The Sadler-Bakken Pool is hereby redefined as that accumulation of oil and gas found in the interval from below the base of the Lodgepole Formation to above the top of the Three Forks Formation within the limits of the field as set forth above.

(6) The proper spacing for the development of Zone I in the Sadler-Bakken Pool is hereby set at one well per 160 acres.

(7) All wells hereafter drilled in Zone I in the Sadler-Bakken Pool shall be located not less than 500 feet from a spacing unit boundary. Wells presently permitted to or producing from the pool that do not conform to this spacing pattern shall be considered exceptions.

(8) Spacing units in Zone I in the Sadler-Bakken Pool shall consist of a governmental quarter section or governmental lots corresponding thereto.

(9) Provisions established herein for Zone II in the Sadler-Bakken Pool are for the exclusive purpose of drilling horizontal wells. Existing and future vertical and directional wells drilled within the area defined as Zone II in paragraph (4) above shall conform to the applicable spacing requirements for the orderly development of Zone I in the Sadler-Bakken Pool.

(10) The proper spacing for the development of Zone II in the Sadler-Bakken Pool is hereby set at one horizontal well per 640 acres.

(11) All portions of the well bore not isolated by cement of any horizontal well hereafter drilled in Zone II in the Sadler-Bakken Pool shall be no closer than 660 feet to the boundary of the spacing unit. Measurement inaccuracies in the directional survey equipment need not be considered except when determined necessary by the Director.

(12) Spacing units in Zone II in the Sadler-Bakken Pool shall consist of a governmental section or governmental lots corresponding thereto.

(13) Zone II in the Sadler-Bakken Pool shall not be extended except by further order of the Commission after due notice and hearing.

(14) Provisions established herein for Zone III in the Sadler-Bakken Pool are for the exclusive purpose of drilling horizontal wells. Existing and future vertical and directional wells drilled within the area defined as Zone III in paragraph (4) above shall conform to the applicable spacing requirements for the orderly development of Zone I in the Sadler-Bakken Pool.

(15) The proper spacing for the development of Zone III in the Sadler-Bakken Pool is hereby set at one horizontal well per 1280 acres.

(16) All portions of the well bore not isolated by cement of any horizontal well hereafter drilled in Zone III in the Sadler-Bakken Pool shall be no closer than 660 feet to the boundary of the spacing unit. Measurement inaccuracies in the directional survey equipment need not be considered except when determined necessary by the Director.

(17) Sections 2 and 11; Sections 14 and 23; Sections 15 and 22, and Sections 16 and 21, Township 161 North, Range 95 West, Divide County, North Dakota, are hereby designated 1280-acre spacing units in Zone III in the Sadler-Bakken Pool.

(18) Spacing units hereafter created in Zone III in the Sadler-Bakken Pool shall consist of two adjacent governmental sections or governmental lots corresponding thereto.

(19) Zone III in the Sadler-Bakken Pool shall not be extended except by further order of the Commission after due notice and hearing.

(20) The operator of any horizontally drilled well in the Sadler-Bakken Pool shall cause to be made a directional survey of the well bore. The directional survey contractor shall file a certified survey with the Commission within 30 days after completion of the well in accordance with NDAC Section 43-02-03-25. The survey shall be of sufficient quality to enable the Commission to determine the entire completion location of the well and its terminus.

(21) The Director is hereby authorized to exercise continuing jurisdiction to determine whether any well proposed or drilled upon any spacing unit herein established has justified the creation of such unit, to require amendments or modifications to the permit to drill for such well, and to deny a permit to drill in the event a well is proposed to be drilled in a manner inconsistent with the evidence that justified the spacing requirements in the Sadler-Bakken Pool.

(22) The Commission shall have continuing jurisdiction in this matter and specifically reserves the authority, upon its own motion or the motion of any interested party, to: (1) review the spacing requirements for the Sadler-Bakken Pool; (2) determine whether the separate zones of spacing established herein are warranted; and, (3) make such further amendments or modifications to the spacing requirements for the Sadler-Bakken Pool as the Commission deems appropriate.

(23) No well shall be hereafter drilled or produced in the Sadler-Bakken Pool, as defined herein, except in conformity with the regulations above without special order of the Commission after due notice and hearing.

(24) The following rules concerning the casing, tubing and equipping of wells shall apply to the subsequent drilling and operation of wells in the Sadler-Bakken Pool:

- (a) The surface casing shall consist of new or reconditioned pipe that has been previously tested to 1000 pounds per square inch. The casing shall be set and cemented at a point not less than 50 feet below the base of the Fox Hills Formation. Sufficient cement shall be used to fill the annular space outside the pipe to the surface of the ground or the bottom of the cellar, and sufficient scratchers and centralizers shall be used to assure a good cement job. Cement shall be allowed to stand a minimum of 12 hours before drilling the plug or initiating tests. The quality of cement shall conform to the standards provided under NDAC Section 43-02-03-21;
- (b) The producing or oil string shall consist of new or reconditioned pipe that has been previously tested to 2000 pounds per square inch. Casing shall be set and cemented at a point not higher than the top of the producing formation, or at a point approved by the Director. Sufficient cement shall be used and applied in such manner to protect and isolate all formations containing oil and/or gas, protect the pipe through salt sections encountered, and to isolate the Dakota-Lakota Series. The cement shall be allowed to stand a minimum of 15 hours before drilling the plug or initiating tests. The quality of cement shall conform to the standards provided under NDAC Section 43-02-03-21. After cementing, the casing shall be tested by application of pump pressure of at least 2000 pounds per square inch. If, at the end of 30 minutes this pressure shall have dropped 150 pounds per square inch or more, the casing shall be repaired. Thereafter, the casing shall again be tested in the same manner. Further work shall not proceed until a satisfactory test has been obtained;
- (c) All well-head fittings and connections shall have a working pressure in excess of that to which they are expected to be subjected; and,
- (d) All wells shall be equipped with tubing; a tubing packer must also be utilized in flowing wells unless a waiver is obtained from the Director after demonstrating the casing will not be subjected to excessive pressure or corrosion; all tubing shall be of sufficient internal diameter to allow the passage of a bottom hole pressure gauge for the purpose of obtaining bottom hole pressure measurements.

(25) The gas-oil ratio of all wells not connected to a gas gathering system shall be measured annually during the month of May. The reservoir pressure shall be measured within 45 days in all wells hereinafter completed in the Sadler-Bakken Pool. Drill stem test pressures are acceptable for determining reservoir pressure. Pressure measurements shall be made at or adjusted to a subsea datum of 6280 feet after the well has been shut in for a minimum of 48 hours. All gas-oil ratio and reservoir pressure determinations shall be made by methods

approved by the Director and reported to the Director within 15 days following the end of the month in which they are determined. The Director is authorized to waive these requirements if the necessity therefor can be demonstrated to his satisfaction. All additional gas-oil ratio and reservoir pressure determinations conducted on any well, but not specifically required herein, shall be reported to the Director within 15 days following the end of the month in which they are determined.

(26) No saltwater, drilling mud, crude oil, or waste oil shall be stored in pits in this field, except in an emergency, and approved by the Director.

(27) All wells in the Sadler-Bakken Pool shall be allowed to produce at a maximum efficient rate for a period of 30 days commencing on the first day oil is produced through well-head equipment into tanks from the ultimate producing interval after casing has been run; thereafter, oil production from such wells shall not exceed an average of 100 barrels of oil per day; if and when such wells are connected to a gas gathering and processing facility the foregoing restrictions shall be removed, and the wells shall be allowed to produce at a maximum efficient rate.

(28) If the flaring of gas produced with crude oil from the Sadler-Bakken Pool causes, or threatens to cause, degradation of ambient air quality, production from the pool shall be further restricted.

(29) This order shall cover all of the Sadler-Bakken Pool common source of supply of crude oil and/or natural gas as herein defined, and all provisions of the pool shall continue in full force and effect until further order of the Commission or until the last well in the pool has been plugged and abandoned.

Dated this 27th day of June, 2006.

INDUSTRIAL COMMISSION
STATE OF NORTH DAKOTA

By the Director, on behalf of the Commission

/s/ Lynn D. Helms, Director

STATE OF NORTH DAKOTA

AFFIDAVIT OF MAILING

COUNTY OF BURLEIGH

I, Marge Rixen, being duly sworn upon oath, depose and say: That on the 30th day of June, 2006 enclosed in separate envelopes true and correct copies of the attached Order No. 10557 of the North Dakota Industrial Commission, and deposited the same with the United States Postal Service in Bismarck, North Dakota, with postage thereon fully paid, directed to the following persons by the Industrial Commission in Case No. 8987:

JOHN MORRISON
FLECK MATHER & STRUTZ LTD
PO BOX 2798
BISMARCK ND 58502

NEIL OLESEN
CONTINENTAL RESOURCES INC
PO BOX 1032
ENID OK 73702-1032

LAWRENCE BENDER
PEARCE & DURICK
PO BOX 400
BISMARCK ND 58502-0400

JIM CANON
CONTINENTAL RESOURCES INC
PO BOX 1032
ENID OK 73702-1032

GENE CARLSON
CONTINENTAL RESOURCES INC
PO BOX 1032
ENID OK 73702-1032

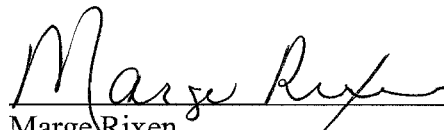

Marge Rixen
Oil & Gas Division

On this 30th day of June, 2006 before me personally appeared Marge Rixen to me known as the person described in and who executed the foregoing instrument and acknowledged that she executed the same as her free act and deed.

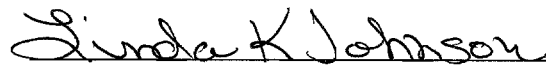

Notary Public
State of North Dakota, County of Burleigh

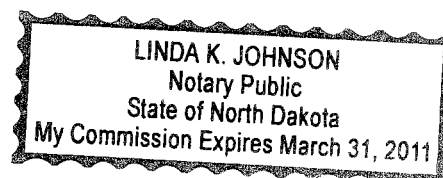

BEFORE THE INDUSTRIAL COMMISSION
OF THE STATE OF NORTH DAKOTA

Case No. 8987

In the matter of the application of Continental Resources, Inc. for an order of the Commission extending the field boundaries and amending the field rules for the Sadler-Bakken pool so as to create and establish two 1280-acre spacing units comprised of all of Sections 2 and 11 and Sections 14 and 23, Township 161 North, Range 95 West, Divide County, North Dakota, authorizing the drilling of one horizontal well on each spacing unit, and/or such other and further relief as the Commission deems appropriate.



TELEPHONIC COMMUNICATION AFFIDAVIT

Jim Canon being first duly sworn deposes and states as follows: That on May 25, 2006, I testified under oath before the North Dakota Industrial Commission in Case Number 8987. My testimony was presented by telephone from (580) 233-8955, at the offices of and on behalf of Continental Resources, Inc., 302 N. Independence Avenue, Enid, Oklahoma 73702-1032.

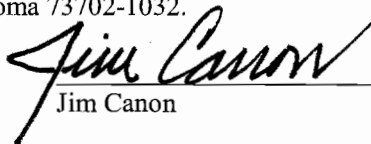

Jim Canon

STATE OF OKLAHOMA)
)ss:
COUNTY OF GARFIELD)

On May 31, 2006, Jim Canon of Continental Resources, Inc., known to me to be the person described in and who executed the foregoing instrument, personally appeared before me and acknowledged that he executed the same as a free act and deed.

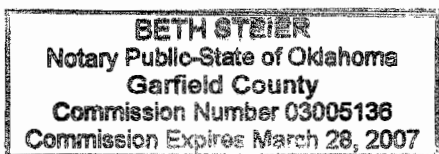

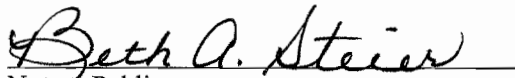

Notary Public
County of Garfield, State of Oklahoma
My Commission Expires: March 26, 2007

BEFORE THE INDUSTRIAL COMMISSION
OF THE STATE OF NORTH DAKOTA

Case No. 8987

In the matter of the application of Continental Resources, Inc. for an order of the Commission extending the field boundaries and amending the field rules for the Sadler-Bakken pool so as to create and establish two 1280-acre spacing units comprised of all of Sections 2 and 11 and Sections 14 and 23, Township 161 North, Range 95 West, Divide County, North Dakota, authorizing the drilling of one horizontal well on each spacing unit, and/or such other and further relief as the Commission deems appropriate.



TELEPHONIC COMMUNICATION AFFIDAVIT

Neil Oleson being first duly sworn deposes and states as follows: That on May 25, 2006, I testified under oath before the North Dakota Industrial Commission in Case Number 8987. My testimony was presented by telephone from (580) 233-8955, at the offices of and on behalf of Continental Resources, Inc., 302 N. Independence Avenue, Enid, Oklahoma 73702-1032.

Neil Oleson

STATE OF OKLAHOMA)
)ss:
COUNTY OF GARFIELD)

On May 31, 2006, Neil Oleson of Continental Resources, Inc., known to me to be the person described in and who executed the foregoing instrument, personally appeared before me and acknowledged that he executed the same as a free act and deed.

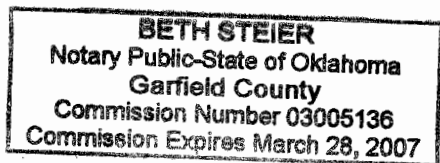

Notary Public
County of Garfield, State of Oklahoma
My Commission Expires: March 28, 2007

BEFORE THE INDUSTRIAL COMMISSION

OF THE STATE OF NORTH DAKOTA

Case No. 8987

In the matter of the application of Continental Resources, Inc. for an order of the Commission extending the field boundaries and amending the field rules for the Sadler-Bakken pool so as to create and establish two 1280-acre spacing units comprised of all of Sections 2 and 11 and Sections 14 and 23, Township 161 North, Range 95 West, Divide County, North Dakota, authorizing the drilling of one horizontal well on each spacing unit, and/or such other and further relief as the Commission deems appropriate.



TELEPHONIC COMMUNICATION AFFIDAVIT

Gene Carlson being first duly sworn deposes and states as follows: That on May 25, 2006, I testified under oath before the North Dakota Industrial Commission in Case Number 8987. My testimony was presented by telephone from (580) 233-8955, at the offices of and on behalf of Continental Resources, Inc., 302 N. Independence Avenue, Enid, Oklahoma 73702-1032.

Gene Carlson
Gene Carlson

STATE OF OKLAHOMA)
)ss:
COUNTY OF GARFIELD)

On May 31, 2006, Gene Carlson of Continental Resources, Inc., known to me to be the person described in and who executed the foregoing instrument, personally appeared before me and acknowledged that he executed the same as a free act and deed.

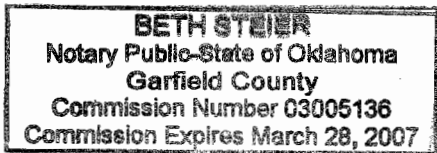

Beth A. Steier
Notary Public
County of Garfield, State of Oklahoma
My Commission Expires: March 28, 2007



CASE NO. 8986

Application for Spacing Unit
All of Sections 8 and 17-T159N-R95W
All of Sections 20 and 29-T159N-R95W
All of Sections 21 & 28-T159N-R95W

Williams County, North Dakota

CASE NO. 8987-8988

Application for Spacing Unit
All of Sections 2 & 11-T161N-R95W
All of Sections 14 & 23-T161N-R95W
All of Sections 24 & 25-T161N-R95W

Divide County, North Dakota

CASE NO. 8990-8991

Applications for Drilling Unit
All of Sections 1 & 12-T160N-R96W
All of Section 1-T161N-R95W & All of Section 36-T162N-R95W

Divide County, North Dakota

Before the
North Dakota Industrial Commission
May 25, 2006

***LAND
EXHIBITS***

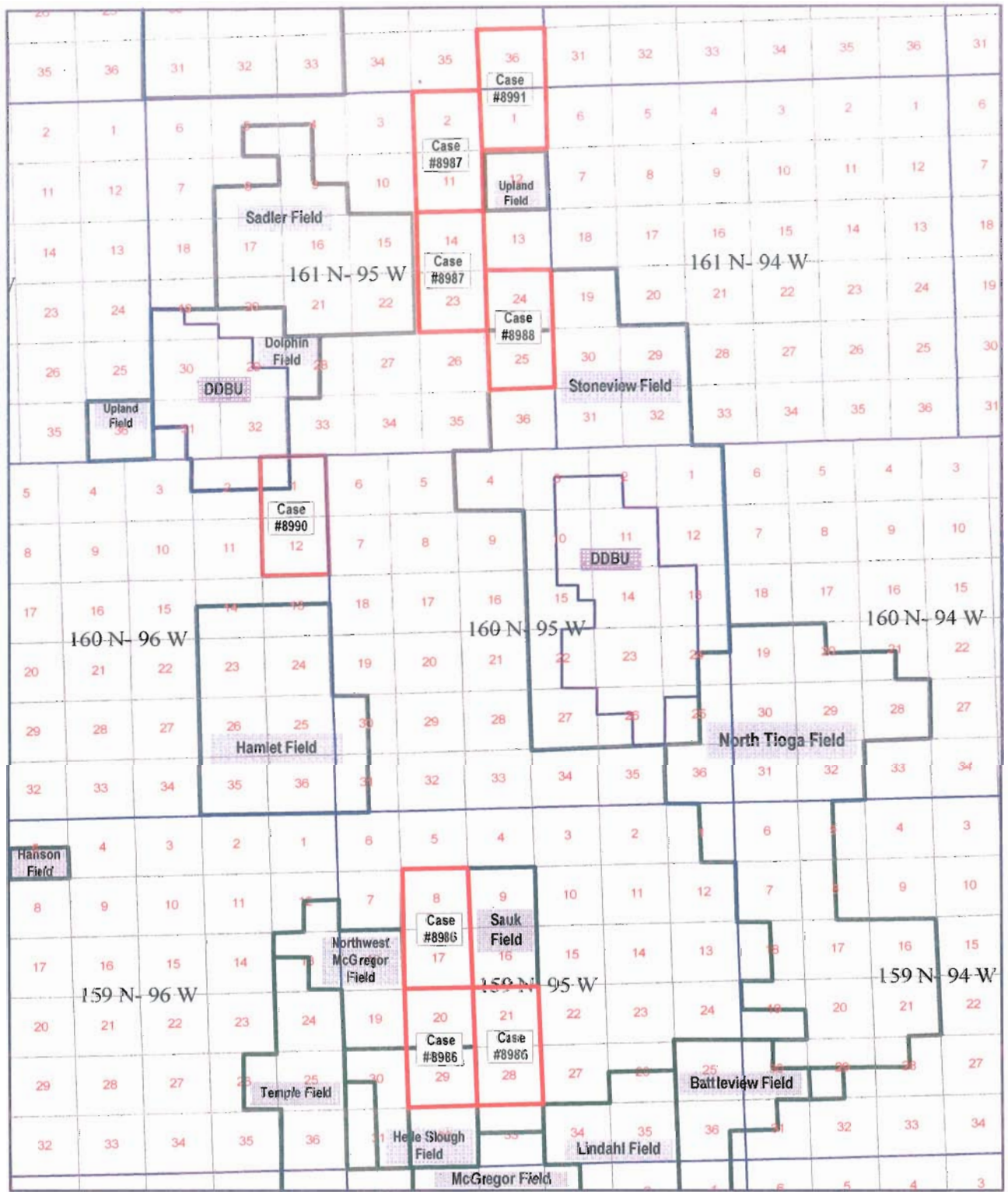

Proposed Drilling and Spacing Units



Unit Outlines



Field Outlines

INDUSTRIAL COMMISSION

STATE OF NORTH DAKOTA

DATE: 05-25-06 CASE NO. 8986, 8987, 8988, 8990, 8991

Introduced By Continental Resources, Inc.

Exhibit L-1

Identified By Jim Cannon

CONTINENTAL
RESOURCES, INC.

Exhibit L-1
Case No. 8986, 8987,
8988, 8990 & 8991

General Locator Map

Land Plat

Township 159 North, Range 95 West
All of Sections 8 & 17
Williams County, North Dakota

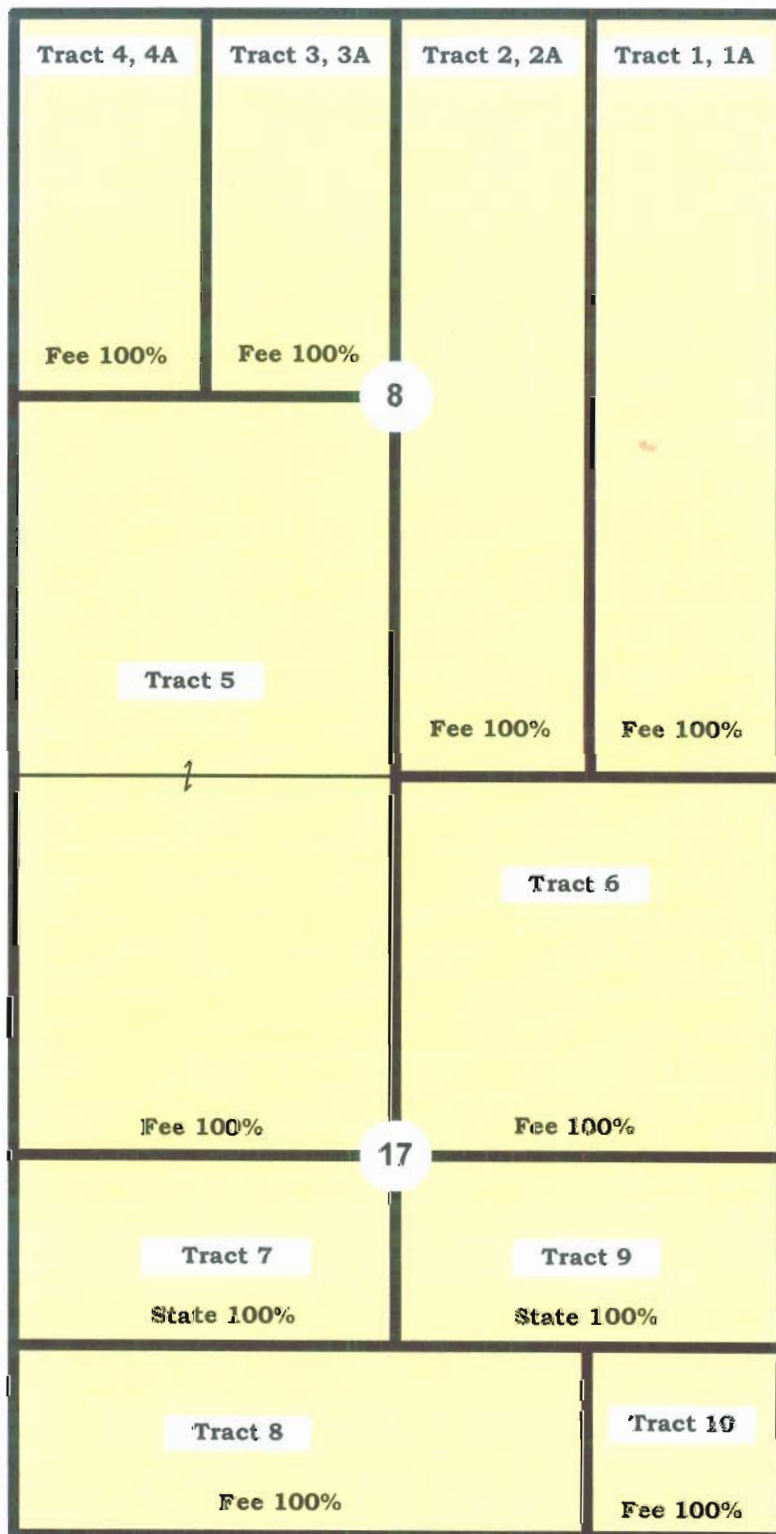

INDUSTRIAL COMMISSION
STATE OF NORTH DAKOTA
DATE 05-25-06 CASE NO. 8986, 8987, 8988, 8990, 8991
Introduced By CR1
Exhibit L-2
Identified By CANON



Unit Acreage Total - 1280.00 Acres

Ownership Summary

Township 159 North, Range 95 West
All of Sections 8 & 17
Williams County, North Dakota

Working Interest in Unit Area

<u>Leasehold Owner</u>	<u>Interest</u>
Continental Resources, Inc.	34.90%
R.D. Evitt	28.21%
Samson Resources Co.	24.75%
Teck Resources (U.S.), Inc.	3.07%
Wheatland Oil, Inc.	1.86%
Burlington Northern and Santa Fe Railway Company	1.39%
BTA Williston Acquisition Partners	1.29%
Kye Trout (Zoltex)	0.77%
W.L. Braun Oil Properties Revocable Trust	0.71%
Headington Oil, LP	0.62%
Landmark Oil & Gas, LLC	0.50%
Northern Energy Corporation	0.50%
Rock Resources, Inc.	0.43%
Ray Reid	0.37%
Lou N. Pokress	0.35%
Henry I. Dreyfus	0.17%
Camwest Exploration, LLC	0.05%
Nance Petroleum Corporation	0.05%
R.W. Porter	0.01%
	<hr/>
	100.00%

Leasehold Ownership

Tract 1: E2E2 less a 3.80 acre tract deeded to Railway, more fully described in Book Y, Page 45 of Section 8-159N-95W, 5th PM

R.D. Evitt	90.00%
Teck Resources (U.S.), Inc.	10.00%

Tract 1A: A 3.80 acre tract in the E2E2 deeded to Railway, more fully described in Book Y, Page 45 of Section 8-159N-95W, 5th PM

Burlington Northern and Sante Fe Railway Company	100.00%
--	---------

INDUSTRIAL COMMISSION
STATE OF NORTH DAKOTA
DATE 05-25-06 CASE NO. 8986, 8987, 8988, 8989, 8990, 8991
Introduced By CRF
Exhibit L-3
Identified By Carson

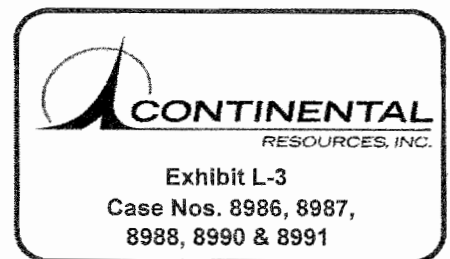

Tract 2: W2E2, less and except a 4.66 acre tract more fully described in Book Y, Page 48 and less a 1.30 acre tract more fully described in Book Y, Page 173 of Section 8-159N-95W, 5th PM

R.D. Evitt	81.11%
Teck Resources (U.S.), Inc.	8.57%
BTA Williston Acquisition Partners	7.14%
Rock Resources, Inc.	2.38%
Nance Petroleum Corporation	0.40%
Camwest Exploration, LLC	0.40%

Tract 2A: A 4.66 acre tract more fully described in Book Y, Page 48 and a 1.30 acre tract more fully described in Book Y, Page 173 in the NW4SE4 of Section 8-159N-95W, 5th PM

Burlington Northern and Santa Fe Railway Company 100.00%

Tract 3: E2NW4 less and except a 2.80 acre tract more fully described in Book Y, Page 41 of Section 8-159-95W, 5th PM

R.D. Evitt	39.33%
Kye Trout (Xoltex)	12.72%
W.L. Braun Oil Properties Revocable Trust	11.83%
Landmark Oil & Gas, LLC	8.34%
Northern Energy Corporation	8.34%
Lou N. Pokress	5.73%
BTA Williston Acquisition Partners	4.79%
Teck Resources (U.S.), Inc.	4.28%
Henry I. Dreyfus	2.86%
Rock Resources, Inc.	1.60%
R.W. Porter	0.18%

Tract 3A: A 2.80 acre tract in the SE4NW4 more fully described in Book Y, Page 41 of Section 8-159N-95W, 5th PM

Burlington Northern and Santa Fe Railway Company 100.00%

Tract 4: W2NW4, less and except a 3.54 acre tract more fully described in Book Y, Page 44 and less a 1.65 acre tract more fully described in Book 65, Page 143 of Section 8-159N-95W, 5th PM

R.D. Evitt	87.14%
Teck Resources (U.S.), Inc.	9.59%
BTA Williston Acquisition Partners	2.45%
Rock Resources, Inc.	0.82%

INDUSTRIAL COMMISSION
STATE OF NORTH DAKOTA
DATE 05-25-04 CASE NO. 8986, 8987, 8988, 8990, 8991
Introduced By CRF
Exhibit L-4
Identified By CANON



Tract 4A: A 3.54 acre tract more fully described in Book Y, Page 44 and a 1.65 acre tract more fully described in Book 65, Page 143 in the SW4NW4 of Section 8-159N-95W, 5th PM

Burlington Northern and Santa Fe Railway Company 100.00%

Tract 5: SW4 of Section 8 and NW4 of Section 17-159N-95W, 5th PM

Continental Resources, Inc. 56.40%
Samson Resources Co. 40.00%
Wheatland Oil, Inc. 3.00%
Ray Reid 0.60%

Tract 6: NE4 of Section 17-159-95W, 5th PM

Continental Resources, Inc. 56.40%
Samson Resources Co. 40.00%
Wheatland Oil, Inc. 3.00%
Ray Reid 0.60%

Tract 7: N2SW4 of Section 17-159N-95W, 5th PM

Continental Resources, Inc. 56.40%
Samson Resources Co. 40.00%
Wheatland Oil, Inc. 3.00%
Ray Reid 0.60%

Tract 8: S2SW4, SW4SE4 of Section 17-159N-95W, 5th PM

Continental Resources, Inc. 56.40%
Samson Resources Co. 40.00%
Wheatland Oil, Inc. 3.00%
Ray Reid 0.60%

Tract 9: N2SE4 of Section 17-159-95W, 5th PM

Continental Resources, Inc. 56.40%
Samson Resources Co. 40.00%
Wheatland Oil, Inc. 3.00%
Ray Reid 0.60%

Tract 10: SE4SE4 of Section 17-159N-95W, 5th PM

Continental Resources, Inc. 45.12%
Samson Resources Co. 32.00%
Headington Oil, LP 20.00%
Wheatland Oil, Inc. 2.40%
Ray Reid 0.48%

INDUSTRIAL COMMISSION
STATE OF NORTH DAKOTA
DATE 05-25-04 CASE NO 8986, 8987, 8988, 8990, 8991
Introduced By CRI
Exhibit L-5
Identified By CANON



Land Plat

Township 159 North, Range 95 West
All of Sections 20 & 29
Williams County, North Dakota

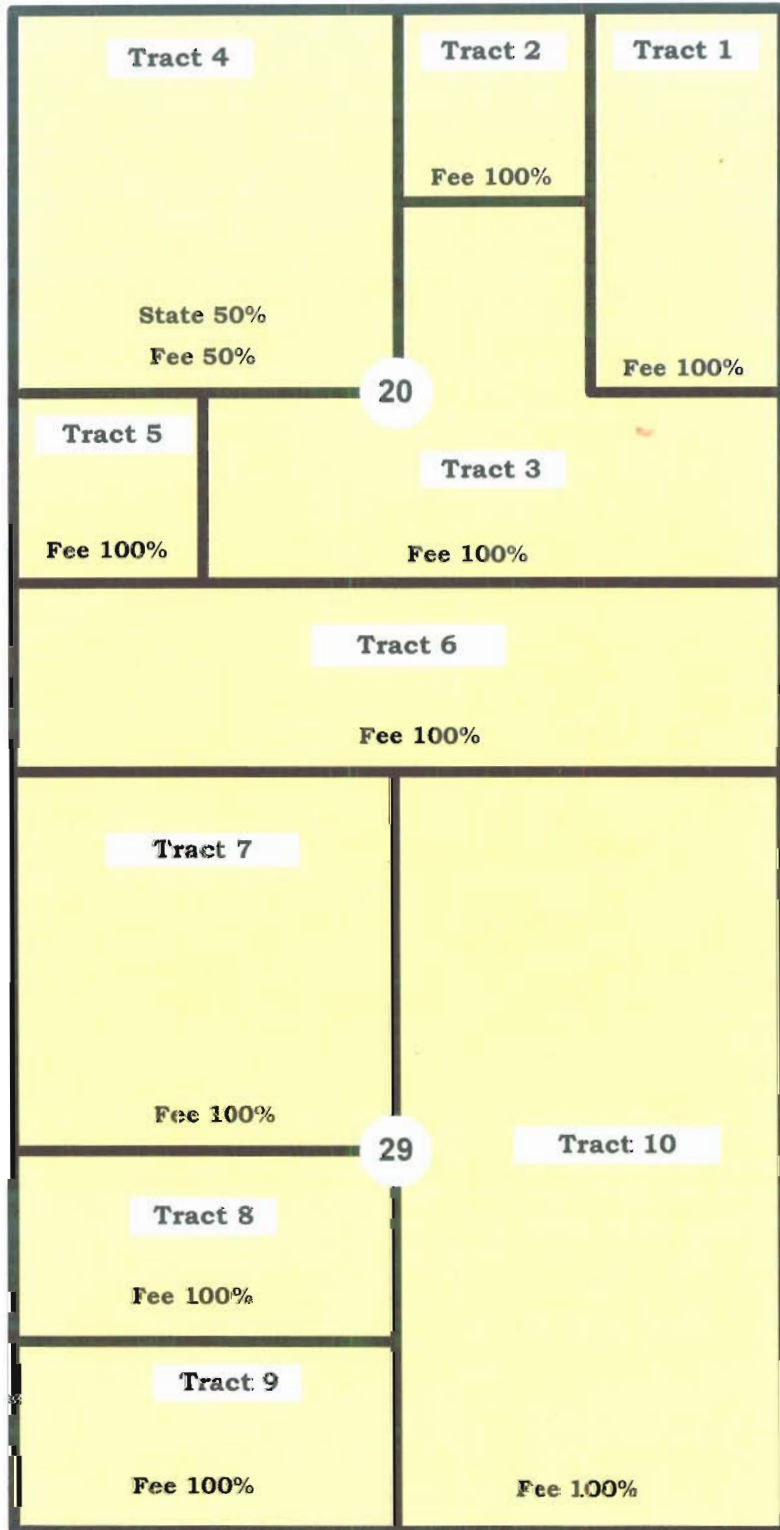

INDUSTRIAL COMMISSION
STATE OF NORTH DAKOTA
DATE 05-25-06 CASE NO. 8986, 8987, 8988, 8990, 8991
Introduced By CPI
Exhibit L-6
Identified By CANON



Unit: Acreage Total - 1280.00 Acres

Ownership Summary

Township 159 North, Range 95 West
All of Sections 20 & 29
Williams County, North Dakota

Working Interest in Unit Area

<u>Leasehold Owner</u>	<u>Interest</u>
Continental Resources, Inc.	39.70%
Samson Resources Co.	29.20%
Phaland, LLC	4.92%
Other	4.69%
Headington Oil, LP	4.30%
J. Hiram Moore, Limited	3.12%
Spectech Threading, Inc.	3.12%
Calvert Drilling & Producing Co.	2.61%
Wheatland Oil, Inc.	2.11%
Kaiser-Francis Oil Company	1.04%
Murex Petroleum Corporation	1.04%
Puckett Investment Co.	0.78%
Jogruss Oil Corporation	0.78%
Kenneth L. Gilchrist/Nominee	0.78%
Shakespeare Oil Co., Inc.	0.49%
Ray Reid	0.42%
HMB Company	0.39%
W.L. Braun Oil Properties Revocable Trust	0.16%
Dalco Oil Company	0.10%
George Clements	0.10%
Lawrence J. Plym	0.10%
Florence A. Brett	0.03%
Paul Quam	0.01%
William Quam	0.01%
	<hr/>
	100.00%

Leasehold Ownership

Tract 1: E2NE4 of Section 20-159N-95W, 5th PM

Other	75.00%
Continental Resources, Inc.	14.10%
Samson Resources Co.	10.00%
Wheatland Oil, Inc.	0.75%
Ray Reid	0.15%

INDUSTRIAL COMMISSION
STATE OF NORTH DAKOTA
DATE 05-25-09 CASE NO. 8986, 8987, 8988
Introduced By CRI
Exhibit L-7
Identified By CANNON

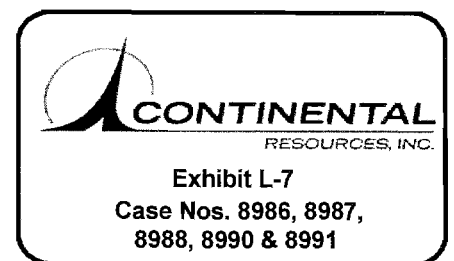

Tract 2: NW4NE4 of Section 20-159N-95W, 5th PM

Continental Resources, Inc.	56.40%
Samson Resources Co.	40.00%
Wheatland Oil, Inc.	3.00%
Ray Reid	0.60%

Tract 3: SW4NE4, NE4SW4, N2SE4 of Section 20-159N-95W, 5th PM

Headington Oil, LP	34.38%
Puckett Investment Co.	25.00%
Continental Resources, Inc.	19.38%
Samson Resources Co.	13.75%
J. Hiram Moore, Limited	6.25%
Wheatland Oil, Inc.	1.03%
Ray Reid	0.21%

Tract 4: NW4 of Section 20-159N-95W, 5th PM

Continental Resources, Inc.	56.40%
Samson Resources Co.	40.00%
Wheatland Oil, Inc.	3.00%
Ray Reid	0.60%

Tract 5: NW4SW4 of Section 20-159N-95W, 5th PM

Continental Resources, Inc.	55.39%
Samson Resources Co.	39.28%
Wheatland Oil, Inc.	2.95%
Florence A. Brett	0.89%
Ray Reid	0.59%
Paul Quam	0.45%
William Quam	0.45%

Tract 6: S2S2 of Section 20-159N-95W, 5th PM

Continental Resources, Inc.	56.40%
Samson Resources Co.	40.00%
Wheatland Oil, Inc.	3.00%
Ray Reid	0.60%

INDUSTRIAL COMMISSION
STATE OF NORTH DAKOTA
DATE 05-25-06 CASE NO. 8986, 8987, 8988, 8990, 8991
Introduced By CRI
Exhibit L-8
Identified By CANON



Tract 7: NW4 of Section 29-159N-95W, 5th PM

Continental Resources, Inc.	56.40%
Samson Resources Co.	40.00%
Wheatland Oil, Inc.	3.00%
Ray Reid	0.60%

Tract 8: N2SW4 of Section 29-159N-95W, 5th PM

Phaland, LLC	78.71%
Calvert Drilling & Producing Co.	18.75%
W.L. Braun Oil Properties Revocable Trust	2.54%

Tract 9: S2SW4 of Section 29-159N-95W, 5th PM

Calvert Drilling & Producing Co.	22.92%
Samson Resources Co.	16.67%
Kaiser-Francis Oil Company	16.67%
Jogruss Oil Corporation	12.50%
Kenneth L. Gilchrist/Nominee	12.50%
Shakespeare Oil Co., Inc.	7.81%
HMB Company	6.25%
Dalco Oil Company	1.56%
George Clements	1.56%
Lawrence J. Plym	1.56%

Tract 10: E2 of Section 29-159N-95W, 5th PM

Continental Resources, Inc.	47.00%
Samson Resources Co.	33.33%
Spectech Threading, Inc.	12.50%
Murex Petroleum Corporation	4.17%
Wheatland Oil, Inc.	2.50%
Ray Reid	0.50%

INDUSTRIAL COMMISSION
STATE OF NORTH DAKOTA

DATE 05-25-06 CASE NO. 8986, 8987, 8988
8990, 8991

Introduced By CRI

Exhibit L-9

Identified By CANON



Land Plat

Township 159 North, Range 95 West
All of Sections 21 & 28
Williams County, North Dakota

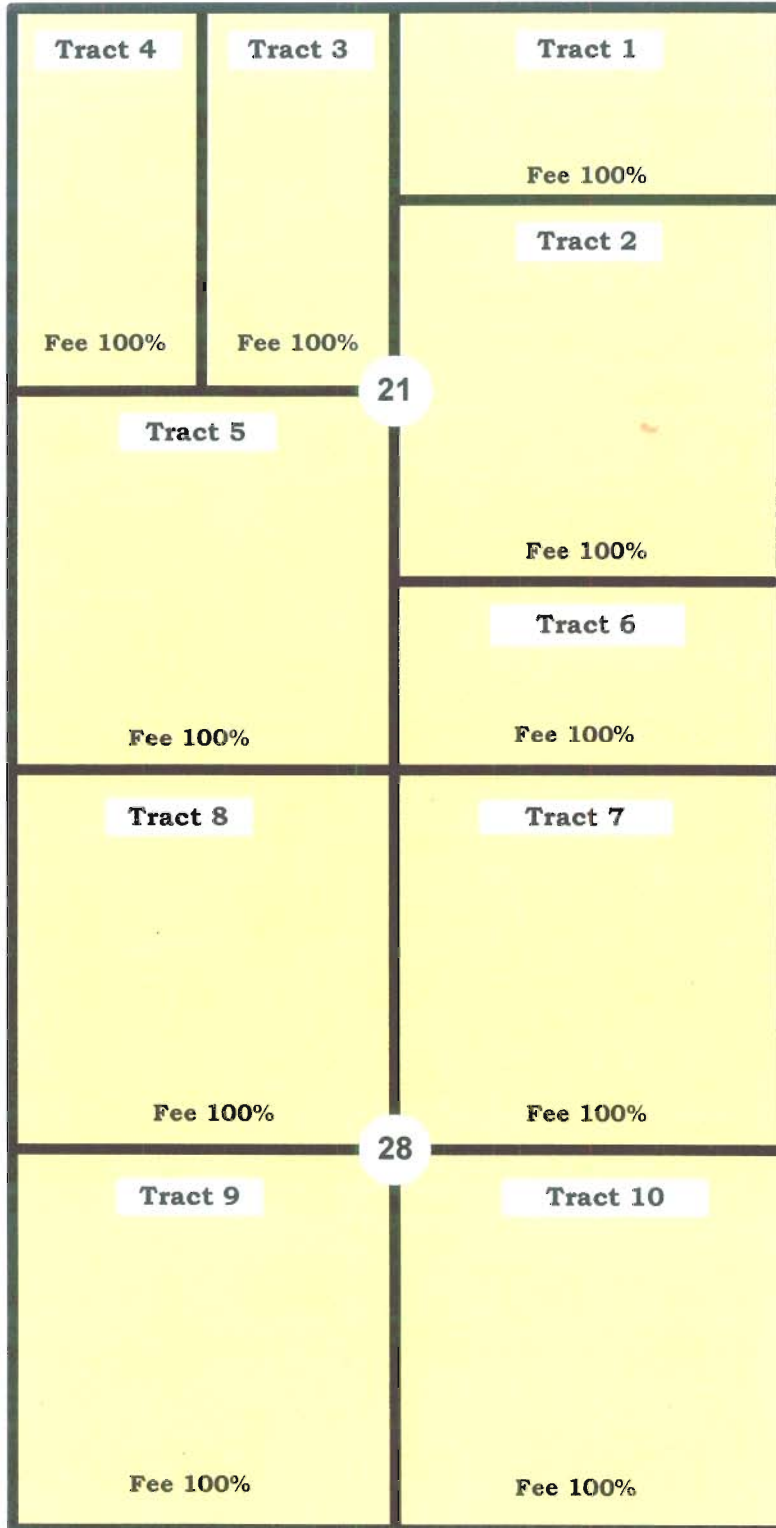

INDUSTRIAL COMMISSION
STATE OF NORTH DAKOTA

DATE 05-25-06 CASE NO. 8986, 8987, 8988, 8989, 8990, 8991

Introduced By CRI

Exhibit L-10

Identified By CANON



CONTINENTAL
RESOURCES, INC.

Exhibit L-10
Case Nos. 8986, 8987,
8988, 8990 & 8991

Unit Acreage Total - 1280.00 Acres

Ownership Summary

Township 159 North, Range 95 West
All of Sections 21 & 28
Williams County, North Dakota

Working Interest in Unit Area

<u>Leasehold Owner</u>	<u>Interest</u>
Continental Resources, Inc.	37.85%
Samson Resources Co.	26.84%
Murex Petroleum Corporation	9.25%
Spec-Tech Threading, Inc.	6.48%
MCNIC Oil & Gas Properties, Inc.	4.50%
North Timbers Limited Partnership	3.52%
Alice H. Cordes	3.13%
Trust created by Last Will & Testament of Benjamin M. Marcus	3.13%
Wheatland Oil, Inc.	2.01%
East Timbers Limited Partnership	1.04%
Cross Timbers Oil Corporation	0.67%
Ray Reid	0.40%
West Timbers Limited Partnership	0.40%
Cathy Jo Aaker Swanson	0.26%
Boedecker Resources	0.19%
Florence A. Brett	0.17%
William Quam	0.08%
Paul Quam	0.08%
	<hr/>
	100.00%

Leasehold Ownership

Tract 1: N2NE4 of Section 21-159-95W, 5th PM

Continental Resources, Inc.	55.39%
Samson Resources Co.	39.28%
Wheatland Oil, Inc.	2.95%
Florence A. Brett	0.89%
Ray Reid	0.59%
William Quam	0.45%
Paul Quam	0.45%

INDUSTRIAL COMMISSION
STATE OF NORTH DAKOTA
DATE 05-25-00 CASE NO. 8986, 8987, 8988, 8990, 8991
Introduced By CRJ
Exhibit L-11
Identified By CANON

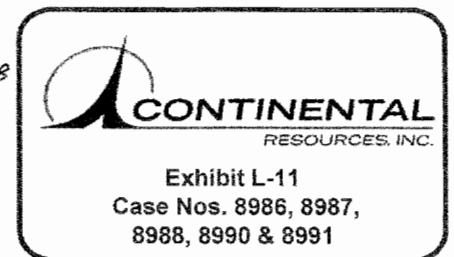

Tract 2: S2NE4, N2SE4 of Section 21-159N-95W, 5th PM

Continental Resources, Inc.	28.20%
Trust created by the Last Will & Testament of Benjamin M. Marcus	25.00%
Alice H. Cordes	25.00%
Samson Resources Co.	20.00%
Wheatland Oil, Inc.	1.50%
Ray Reid	0.30%

Tract 3: E2NW4 of Section 21-159N-95W, 5th PM

Continental Resources, Inc.	48.34%
Samson Resources Co.	34.29%
MCNIC Oil & Gas Properties, Inc.	12.00%
Wheatland Oil, Inc.	2.57%
Florence A. Brett	0.89%
Ray Reid	0.51%
Boedecker Resources	0.50%
William Quam	0.45%
Paul Quam	0.45%

Tract 4: W2NW4 of Section 21-159N-95W, 5th PM

MCNIC Oil & Gas Properties, Inc.	60.00%
Continental Resources, Inc.	20.14%
Samson Resources Co.	14.29%
Boedecker Resources	2.50%
Wheatland Oil, Inc.	1.07%
Florence A. Brett	0.89%
William Quam	0.45%
Paul Quam	0.45%
Ray Reid	0.21%

Tract 5: SW4 of Section 21-159N-95W, 5th PM

Continental Resources, Inc.	44.65%
Samson Resources Co.	31.67%
North Timbers Limited Partnership	9.86%
Murex Petroleum Corporation	4.16%
Cross Timbers Oil Corporation	3.58%
East Timbers Limited Partnership	2.53%
Wheatland Oil, Inc.	2.37%
West Timbers Limited Partnership	0.70%
Ray Reid	0.48%

INDUSTRIAL COMMISSION
STATE OF NORTH DAKOTA
DATE 05-25-06 CASE NO. 8986, 8987, 8988, 8990, 8991
Introduced By CRI
Exhibit L-12
Identified By CANDY

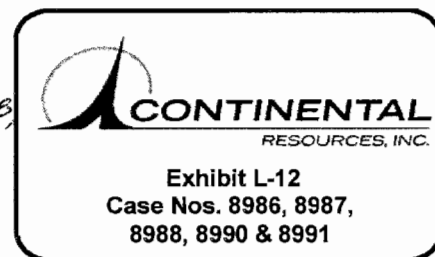

Tract 6: S2SE4 of Section 21-159N-95W, 5th PM

Continental Resources, Inc.	44.65%
Samson Resources Co.	31.67%
North Timbers Limited Partnership	9.86%
Murex Petroleum Corporation	4.16%
Cross Timbers Oil Corporation	3.58%
East Timbers limited Partnership	2.53%
Wheatland Oil, Inc.	2.37%
West Timbers Limited Partnership	0.70%
Ray Reid	0.48%

Tract 7: NE4 of Section 28-159N-95W, 5th PM

Continental Resources, Inc.	56.40%
Samson Resources Co.	40.00%
Wheatland Oil, Inc.	3.00%
Ray Reid	0.60%

Tract 8: NW4 of Section 28-159N-95W, 5th PM

Continental Resources, Inc.	32.90%
Samson Resources Co.	23.33%
Murex Petroleum Corporation	15.42%
North Timbers Limited Partnership	13.34%
Spectech Threading, Inc.	6.25%
East Timbers Limited Partnership	4.53%
West Timbers Limited Partnership	2.13%
Wheatland Oil, Inc.	1.75%
Ray Reid	0.35%

Tract 9: SW4 of Section 28-159N-95W, 5th PM

Murex Petroleum Corporation	52.33%
Spectech Threading, Inc.	45.59%
Cathy Jo Aaker Swanson	2.08%

Tract 10: SE4 of Section 28-159N-95W, 5th PM

Continental Resources, Inc.	56.40%
Samson Resources Co.	40.00%
Wheatland Oil, Inc.	3.00%
Ray Reid	0.60%

INDUSTRIAL COMMISSION
STATE OF NORTH DAKOTA
DATE 05-25-06 CASE NO. 8986, 8987, 8988
8990, 8991
Introduced By CRI
Exhibit L-13
Identified By CANON

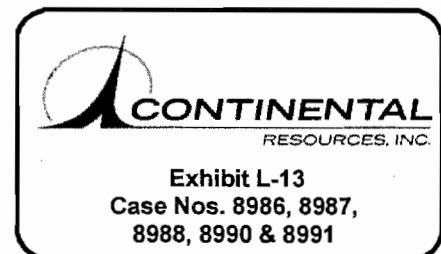

Land Plat

Township 161 North, Range 95 West
All of Sections 2 & 11
Divide County, North Dakota

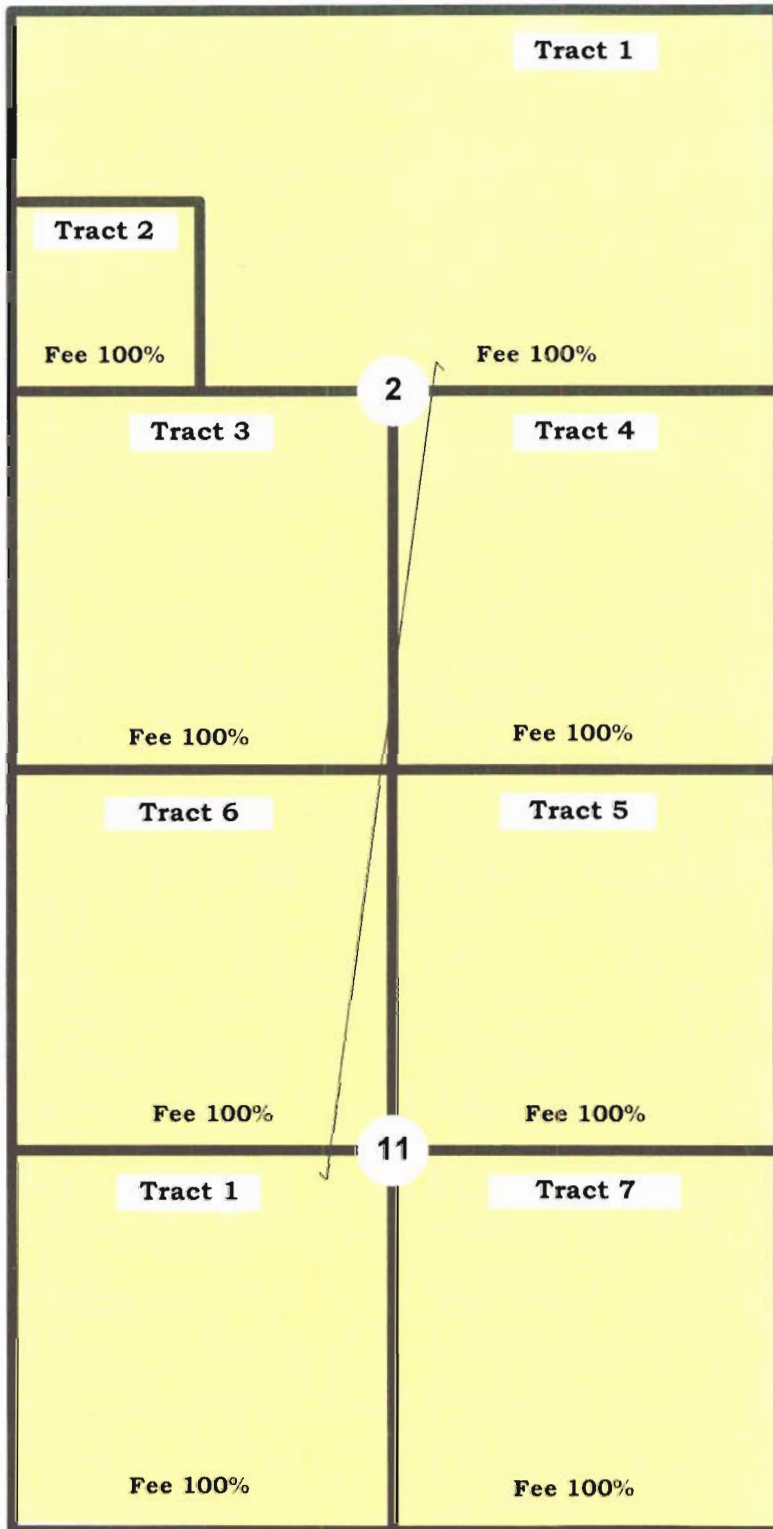

Unit Acreage Total - 1280.32 Acres

INDUSTRIAL COMMISSION
STATE OF NORTH DAKOTA
DATE 0525-06 CASE NO. 8986, 8987, 8988, 8990, 8991
Introduced By CRI
Exhibit 2-14
Identified By CANON



Ownership Summary

Township 161 North, Range 95 West
All of Sections 2 & 11
Divide County, North Dakota

Working Interest in Unit Area

<u>Leasehold Owner</u>	<u>Interest</u>
Continental Resources, Inc.	54.64%
Samson Resources Co.	38.75%
Mammoth Exploration, LLC	3.12%
Wheatland Oil, Inc.	2.91%
Ray Reid	0.58%

Leasehold Ownership

Tract 1: Lots 1, 2, 3, 4, S2NE4, SE4NW4 of Section 2 and SW4 of Section 11-161N-95W, 5th PM

Continental Resources, Inc.	56.40%
Samson Resources Co.	40.00%
Wheatland Oil, Inc.	3.00%
Ray Reid	0.60%

Tract 2: SW4NW4 of Section 2-161N-95W, 5th PM

Continental Resources, Inc.	56.40%
Samson Resources Co.	40.00%
Wheatland Oil, Inc.	3.00%
Ray Reid	0.60%

Tract 3: SW4 of Section 2-161N-95W, 5th PM

Continental Resources, Inc.	56.40%
Samson Resources Co.	40.00%
Wheatland Oil, Inc.	3.00%
Ray Reid	0.60%

Tract 4: SE4 of Section 2-161N-95W, 5th PM

Continental Resources, Inc.	56.40%
Samson Resources Co.	40.00%
Wheatland Oil, Inc.	3.00%
Ray Reid	0.60%

INDUSTRIAL COMMISSION
STATE OF NORTH DAKOTA
DATE 05-25-06 CASE NO. 8986, 8987, 8988, 8989, 8990, 8991
Introduced By CRF
Exhibit L-15
Identified By Canon

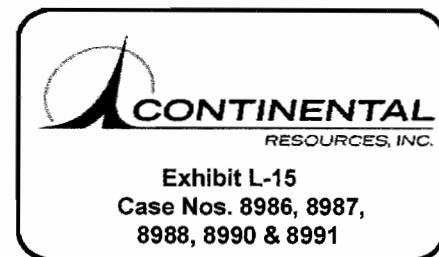

Tract 5: NE4 of Section 11-161N-95W, 5th PM

Continental Resources, Inc.	42.30%
Samson Resources Co.	30.00%
Mammoth Exploration, LLC	25.00%
Wheatland Oil, Inc.	2.25%
Ray Reid	0.45%

Tract 6: NW4 of Section 11-161N-95W, 5th PM

Continental Resources, Inc.	56.40%
Samson Resources Co.	40.00%
Wheatland Oil, Inc.	3.00%
Ray Reid	0.60%

Tract 7: SE4 of Section 11-161N-95W, 5th PM

Continental Resources, Inc.	56.40%
Samson Resources Co.	40.00%
Wheatland Oil, Inc.	3.00%
Ray Reid	0.60%

INDUSTRIAL COMMISSION
STATE OF NORTH DAKOTA
DATE 05-25-00 CASE NO. 8986, 8987, 8988, 8990, 8991
Introduced By ERJ
Exhibit L-16
Identified By CANON

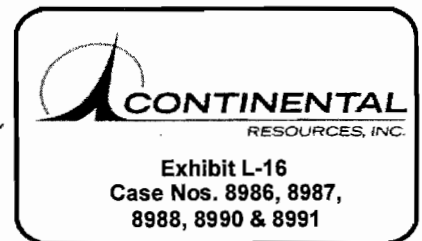

Land Plat

Township 161 North, Range 95 West
All of Sections 14 & 23
Divide County, North Dakota

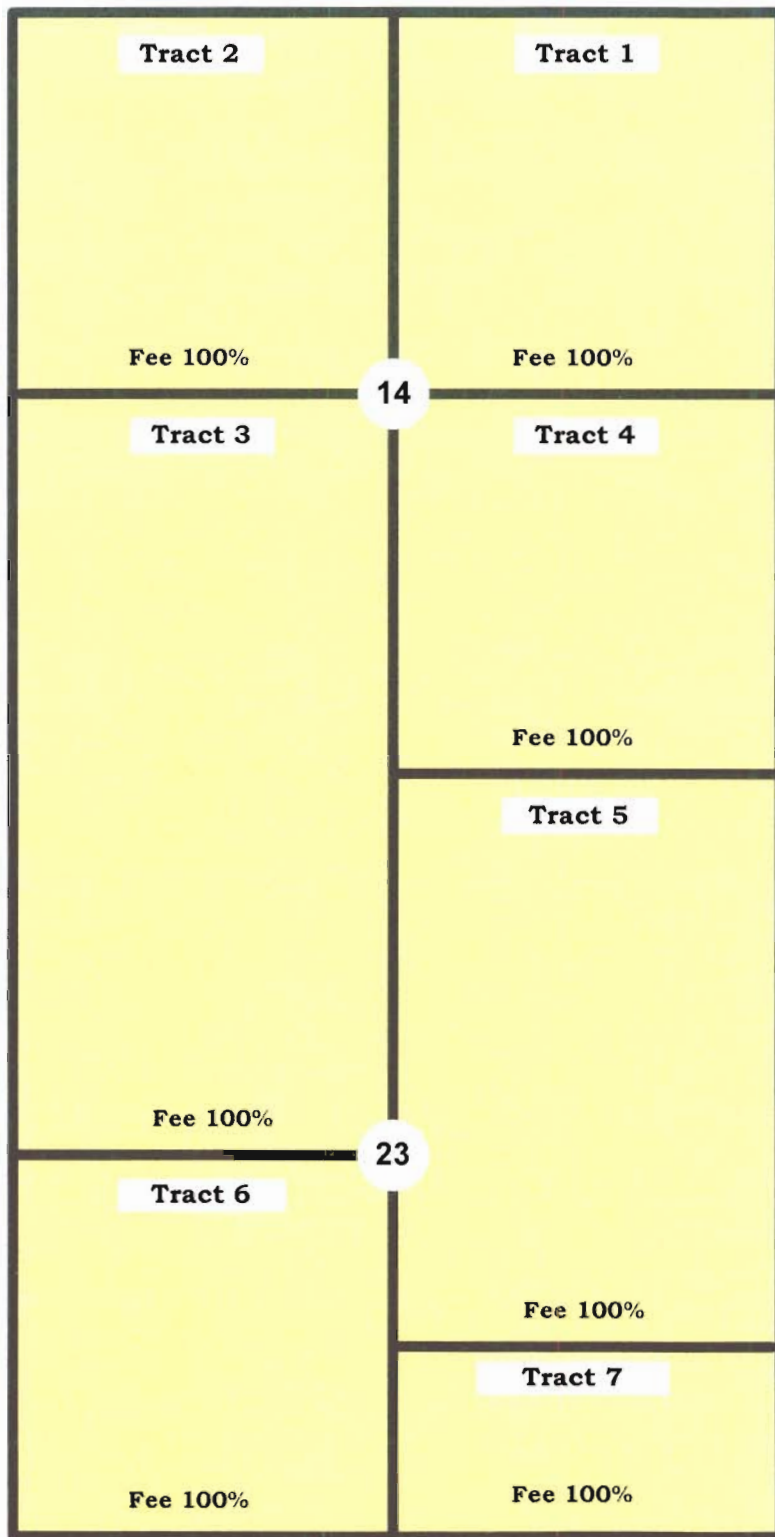

Unit Acreage Total - 1280.00 Acres

INDUSTRIAL COMMISSION
STATE OF NORTH DAKOTA
DATE 05-25-06 CASE NO. 8986, 8987, 8988, 8989, 8990, 8991
Introduced By CRF
Exhibit L-17
Identified By CARDON



Ownership Summary

Township 161 North, Range 95 West
All of Sections 14 & 23
Divide County, North Dakota

Working Interest in Unit Area

<u>Leasehold Owner</u>	<u>Interest</u>
Continental Resources, Inc.	41.69%
Samson Resources Co.	29.57%
Headington Oil, LP	11.87%
Others	4.48%
Mammoth Exploration, LLC	3.13%
The Triple T, Inc.	3.13%
Wheatland Oil, Inc.	2.22%
Lynch Resources, Ltd.	1.26%
Murex Petroleum Corporation	0.91%
B and J Resources, Inc.	0.65%
AA Minerals, LLC	0.65%
Ray Reid	0.44%

Leasehold Ownership

Tract 1: NE4 of Section 14-161N-95W, 5th PM

Continental Resources, Inc.	35.25%
Samson Resources Co.	25.00%
Mammoth Exploration, LLC	25.00%
Headington Oil, LP	12.50%
Wheatland Oil, Inc.	1.88%
Ray Reid	0.37%

Tract 2: NW4 of Section 14-161N-95W, 5th PM

Continental Resources, Inc.	42.30%
Samson Resources Co.	30.00%
The Triple T, Inc.	25.00%
Wheatland Oil, Inc.	2.25%
Ray Reid	0.45%

INDUSTRIAL COMMISSION
STATE OF NORTH DAKOTA
DATE 05-25-06 CASE NO. 8986, 8987, 8988, 8990, 8991
Introduced By CR I
Exhibit L-18
Identified By Canon

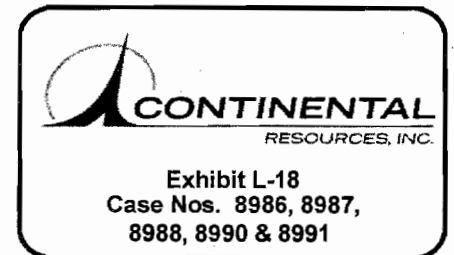

Tract 3: SW4 of Section 14 and NW4 of Section 23-161N-95W, 5th PM

Continental Resources, Inc.	30.84%
Samson Resources Co.	21.88%
Headington Oil, LP	26.26%
Others	8.77%
Lynch Resources, Ltd.	5.06%
B and J Resources, Inc.	2.61%
AA Minerals, LLC	2.61%
Wheatland Oil, Inc.	1.64%
Ray Reid	0.33%

Tract 4: SE4 of Section 14-161N-95W, 5th PM

Continental Resources, Inc.	56.40%
Samson Resources Co.	40.00%
Wheatland Oil, Inc.	3.00%
Ray Reid	0.60%

Tract 5: NE4, N2SE4 of Section 23-161N-95W, 5th PM

Continental Resources, Inc.	36.03%
Samson Resources Co.	25.56%
Headington Oil, LP	19.97%
Others	11.28%
Murex Petroleum Corporation	4.86%
Wheatland Oil, Inc.	1.92%
Ray Reid	0.38%

Tract 6: SW4 of Section 23-161N-95W, 5th PM

Continental Resources, Inc.	56.40%
Samson Resources Co.	40.00%
Wheatland Oil, Inc.	3.00%
Ray Reid	0.60%

Tract 7: S2SE4 of Section 23-161N-95W, 5th PM

Continental Resources, Inc.	54.83%
Samson Resources Co.	38.89%
Wheatland Oil, Inc.	2.92%
Others	2.78%
Ray Reid	0.58%

INDUSTRIAL COMMISSION
STATE OF NORTH DAKOTA
DATE 05-25-09 CASE NO. 8986, 8987, 8988
8990, 8991
Introduced By CRJ
Exhibit L-19
Identified By CANON

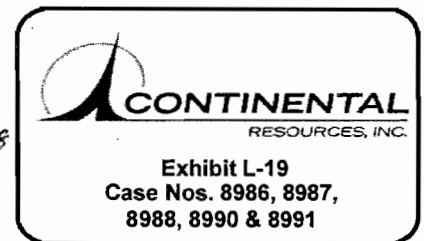

Land Plat

Township 161 North, Range 95 West
All of Sections 24 & 25
Divide County, North Dakota

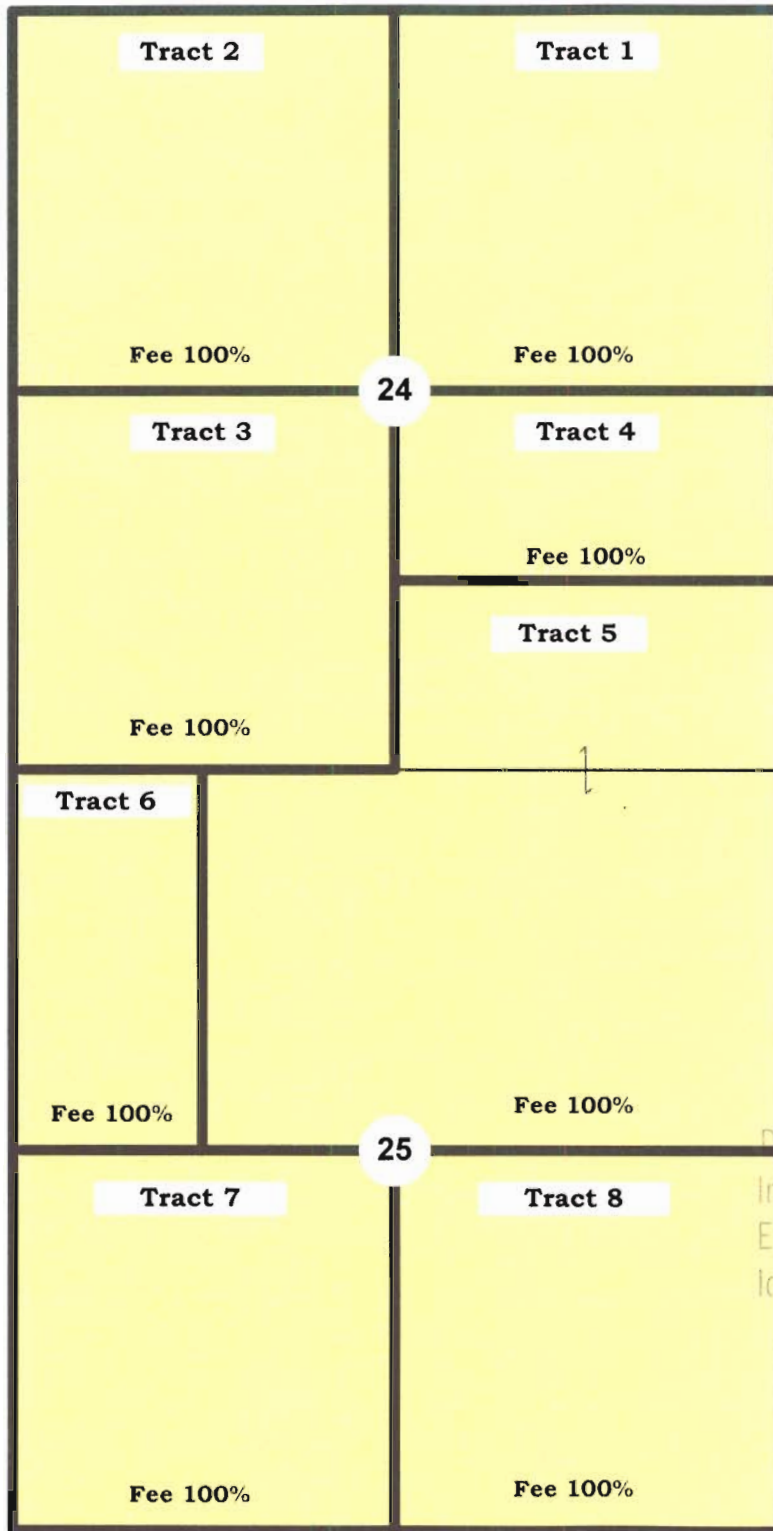

Unit Acreage Total - 1280.00 Acres

INDUSTRIAL COMMISSION
STATE OF NORTH DAKOTA
DATE 05-25-06 CASE NO. 8986, 8987, 8988, 8989, 8990, 8991
Introduced By CRI
Exhibit L-20
Identified By CANON



Ownership Summary

Township 161 North, Range 95 West
All of Sections 24 & 25
Divide County, North Dakota

Working Interest in Unit Area

<u>Leasehold Owner</u>	<u>Interest</u>
Continental Resources, Inc.	33.93%
Samson Resources Co.	24.06%
Jettison, Inc.	12.50%
R.D. Evitt	12.50%
Amerada Hess Corporation	4.85%
Headington Oil, LP	4.40%
Interwest Petroleum Corporation	2.34%
Wheatland Oil, Inc.	1.81%
Melvin Holte	0.79%
Lillian Bratlien Swartz	0.70%
Fortin Enterprises, Inc.	0.68%
Hancock Enterprises	0.68%
Ray Reid	0.36%
Durmont Foundation	0.10%
William Joy Charitable Trust	0.10%
Trust 850 II	0.10%
Northern Energy Corp.	0.05%
Landmark Oil & Gas, LLC	0.05%

Leasehold Ownership

Tract 1: NE4 of Section 24-161N-95W, 5th PM

Continental Resources, Inc.	45.82%
Samson Resources Co.	32.50%
Interwest Petroleum Corporation	18.75%
Wheatland Oil, Inc.	2.44%
Ray Reid	0.49%

INDUSTRIAL COMMISSION
STATE OF NORTH DAKOTA
DATE 05-25-06 CASE NO. 8986, 8987, 8988, 8990, 8991
Introduced By CRI
Exhibit L-21
Identified By CANON



Tract 2: NW4 of Section 24-161N-95W, 5th PM

Continental Resources, Inc.	56.40%
Samson Resources Co.	40.00%
Wheatland Oil, Inc.	3.00%
Ray Reid	0.60%

Tract 3: SW4 of Section 24-161N-95W, 5th PM

Continental Resources, Inc.	56.40%
Samson Resources Co.	40.00%
Wheatland Oil, Inc.	3.00%
Ray Reid	0.60%

Tract 4: N2SE4 of Section 24-161N-95W, 5th PM

Headington Oil, LP	59.09%
Melvin Holte	12.66%
Fortin Enterprises, Inc.	10.94%
Hancock Enterprises	10.94%
Dumont Foundation	1.63%
William Joy Charitable Trust	1.56%
Trust 850 II	1.56%
Northern Energy Corp.	0.81%
Landmark Oil & Gas, LLC	0.81%

Tract 5: S2SE4 of Section 24 and NE4, E2NW4 of Section 25-161N-95W, 5th PM

Continental Resources, Inc.	56.40%
Samson Resources Co.	40.00%
Wheatland Oil, Inc.	3.00%
Ray Reid	0.60%

Tract 6: W2NW4 of Section 25-161N-95W, 5th PM

Amerada Hess Corporation	77.50%
Headington Oil, LP	11.25%
Lillian Bratlien Swartz	11.25%

Tract 7: SW4 of Section 25-161N-95W, 5th PM

R.D. Evitt	50.00%
Jettison, Inc.	50.00%

Tract 8: SE4 of Section 25-161N-95W, 5th PM

R.D. Evitt	50.00%
Jettison, Inc.	50.00%

INDUSTRIAL COMMISSION
STATE OF NORTH DAKOTA
DATE 05-25-06 CASE NO. 8986, 8987, 8988
8990, 8991
Introduced By CRJ
Exhibit L-22
Identified By CAWON

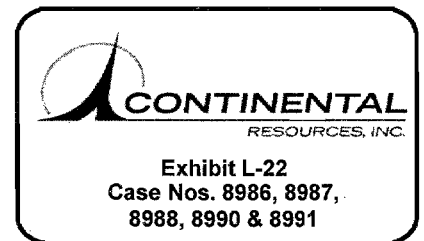

Land Plat

Township 160 North, Range 96 West
All of Sections 1 & 12
Divide County, North Dakota

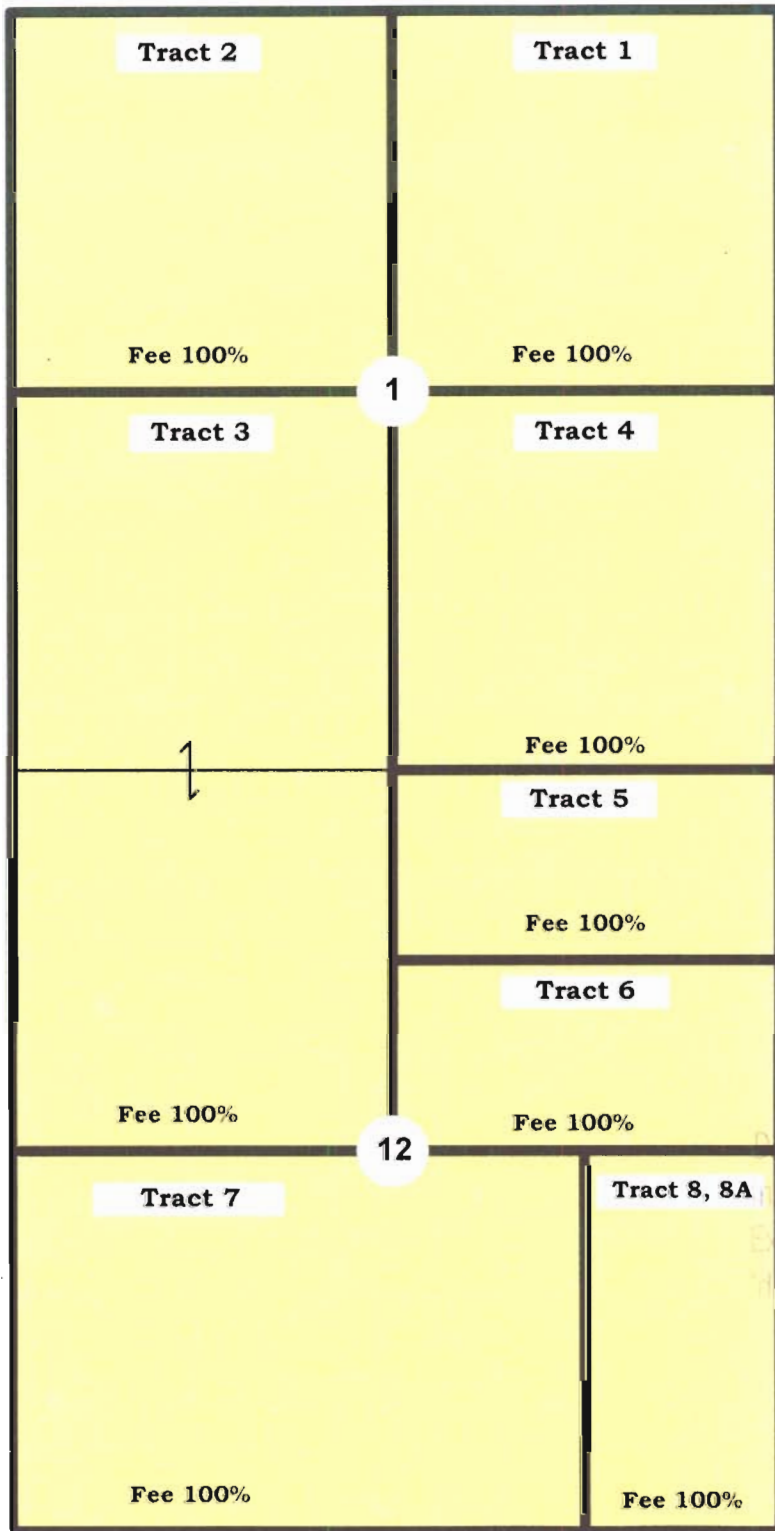

INDUSTRIAL COMMISSION
STATE OF NORTH DAKOTA
DATE 05-25-06 CASE NO. 8986, 8987, 8988, 8990, 8991
Produced By CRI
Exhibit L-23
Identified By CANON



Unit Acreage Total - 1292.24 Acres

Ownership Summary

Township 160 North, Range 96 West

All of Sections 1 & 12

Divide County, North Dakota

Working Interest in Unit Area

<u>Leasehold Owner</u>	<u>Interest</u>
Continental Resources, Inc.	42.16%
Samson Resources Co.	29.90%
Condor Petroleum, Inc.	12.38%
Chesapeake Exploration, LP	10.06%
Wheatland Oil, Inc.	2.25%
KAB Acquisition, LLLP	1.40%
Morse Energy Partners, LLC	1.40%
Ray Reid	0.45%

Leasehold Ownership

Tract 1: Lots 1, 2, S2NE4 of Section 1-160N-96W, 5th PM

Continental Resources, Inc.	56.40%
Samson Resources Co.	40.00%
Wheatland Oil, Inc.	3.00%
Ray Reid	0.60%

Tract 2: Lots 3, 4, S2NW4 of Section 1-160N-96W, 5th PM

Chesapeake Exploration, LP	78.18%
KAB Acquisition, LLLP	10.91%
Morse Energy Partners, LLC	10.91%

Tract 3: SW4 of Section 1 and NW4 of Section 12-160N-96W, 5th PM

Continental Resources, Inc.	56.40%
Samson Resources Co.	40.00%
Wheatland Oil, Inc.	3.00%
Ray Reid	0.60%

INDUSTRIAL COMMISSION
STATE OF NORTH DAKOTA
DATE 05-25-06 CASE NO. 8986, 8987, 8988, 8990, 8991
Introduced By CRF
Exhibit L-24
Identified By CANDY

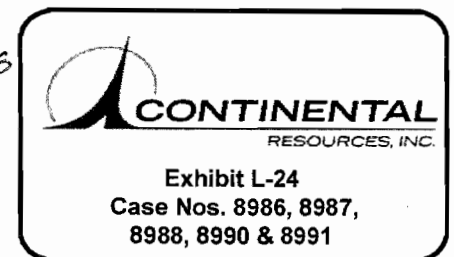

Tract 4: SE4 of Section 1-160N-96W, 5th PM

Continental Resources, Inc.	56.40%
Samson Resources Co.	40.00%
Wheatland Oil, Inc.	3.00%
Ray Reid	0.60%

Tract 5: N2NE4 of Section 12-160N-96W, 5th PM

Condor Petroleum, Inc.	100.00%
------------------------	---------

Tract 6: S2NE4 of Section 12-160N-96W, 5th PM

Condor Petroleum, Inc.	100.00%
------------------------	---------

Tract 7: SW4, W2SE4 of Section 12-160N-96W, 5th PM

Continental Resources, Inc.	56.40%
Samson Resources Co.	40.00%
Wheatland Oil, Inc.	3.00%
Ray Reid	0.60%

Tract 8: E2SE4 Less a 0.32 acre tract more fully described in Book 34, Page 199 of Section 12-160N-96W, 5th PM

Continental Resources, Inc.	56.40%
Samson Resources Co.	40.00%
Wheatland Oil, Inc.	3.00%
Ray Reid	0.60%

Tract 8A: A 0.32 acre tract more fully described in Book 34, Page 199 of Section 12-160N-96W, 5th PM

Continental Resources, Inc.	56.40%
Samson Resources Co.	40.00%
Wheatland Oil, Inc.	3.00%
Ray Reid	0.60%

INDUSTRIAL COMMISSION
STATE OF NORTH DAKOTA
DATE 12-25-06 CASE NO. 898, 899
Introduced By CRF
Exhibit C-25
Identified By CANDOR

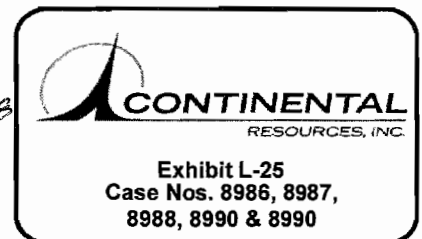

Land Plat

Township 162 North, Range 95 West
All of Section 36 and
Township 161 North, Range 95 West
All of Section 1
Divide County, North Dakota

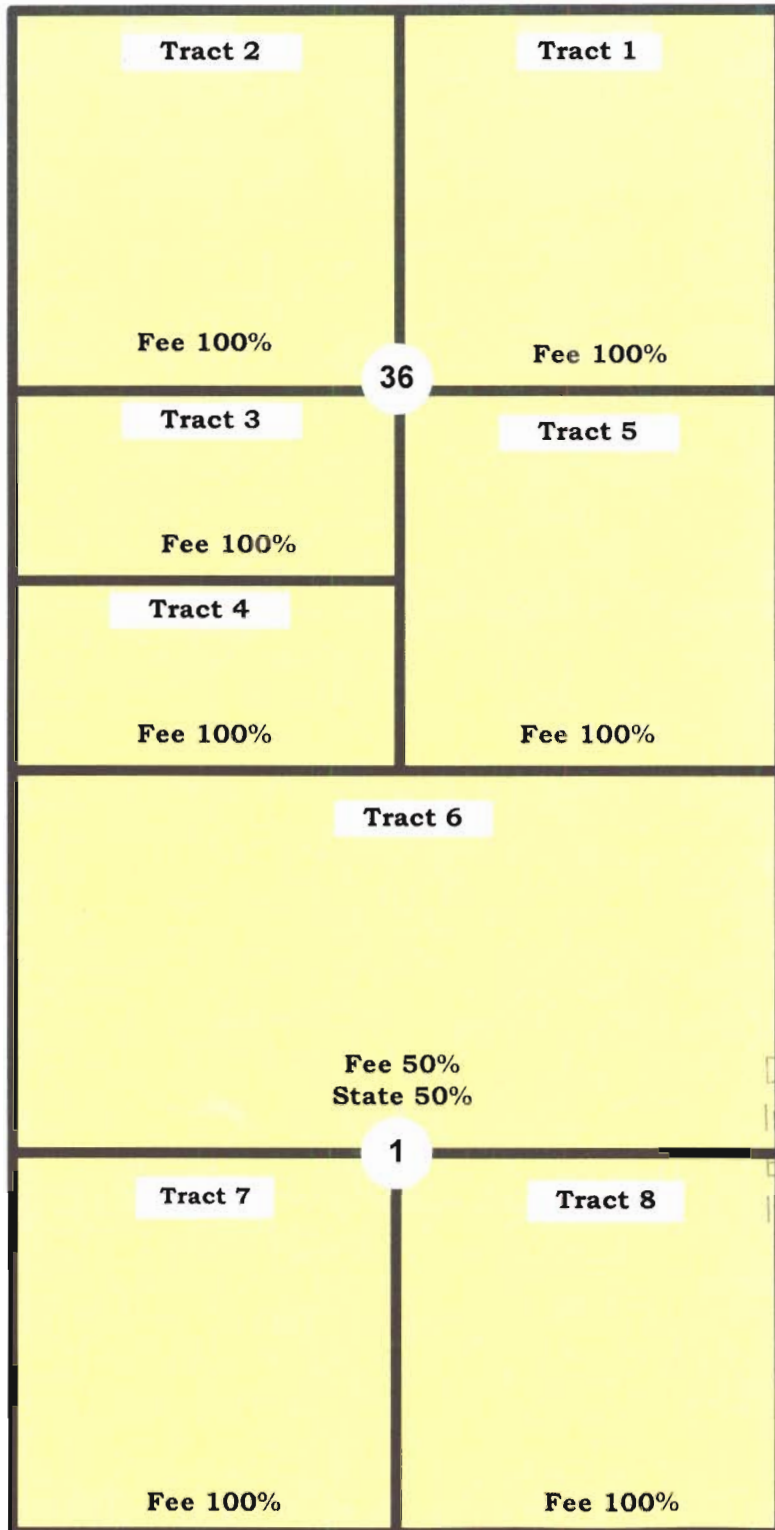

INDUSTRIAL COMMISSION
STATE OF NORTH DAKOTA
DATE 05-25-06 CASE NO. 8986, 8987, 8988, 8989, 8990, 8991
Introduced By CRJ
Exhibit L-26
Identified By CARON



Unit Acreage Total - 1280.32 Acres

Ownership Summary

Township 162 North, Range 95 West
All of Section 36 and
Township 161 North, Range 95 West
All of Section 1
Divide County, North Dakota

Working Interest in Unit Area

<u>Leasehold Owner</u>	<u>Interest</u>
Continental Resources, Inc.	34.37%
Samson Resources Co.	24.37%
Headington Oil, LP	18.75%
Gordon J. Wallin and Thelma A. Wallin Revocable Trust	11.72%
Amerada Hess Corporation	7.82%
Wheatland Oil, Inc.	1.83%
Rev. Trust of George L. Brunelle and Bernice E. Brunelle	0.78%
Ray Reid	0.36%
	100.00%

Leasehold Ownership

Tract 1: NE4 of Section 36-162N-95W, 5th PM

Headington Oil, LP	50.00%
Gordon J. Wallin and Thelma A. Wallin Revocable Trust	50.00%

Tract 2: NW4 of Section 36-162N-95W, 5th PM

Headington Oil, LP	50.00%
Continental Resources, Inc.	28.20%
Samson Resources Co.	20.00%
Wheatland Oil, Inc.	1.50%
Ray Reid	0.30%

Tract 3: N2SW4 of Section 36-162N-95W, 5th PM

Gordon J. Wallin and Thelma A. Wallin Revocable Trust	87.50%
Revocable Trust of George L. Brunelle and Bernice E. Brunelle	12.50%

REGULATORY COMMISSION
STATE OF NORTH DAKOTA
DATE 05-25-00 CASE NO. 8986, 8987, 8988, 8990, 8991
Introduced By CRI
Exhibit L-27
Identified By CANON

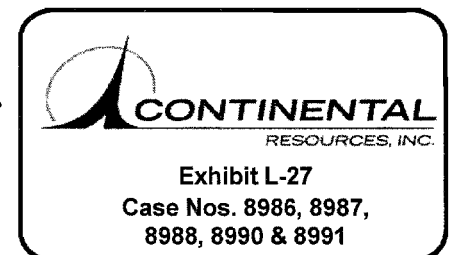

Tract 4: S2SW4 of Section 36-162N-95W, 5th PM

Continental Resources, Inc.	42.30%
Samson Resources Co.	30.00%
Amerada Hess Corporation	25.00%
Wheatland Oil, Inc.	2.25%
Ray Reid	0.45%

Tract 5: SE4 of Section 36-162N-95W, 5th PM

Continental Resources, Inc.	56.40%
Samson Resources Co.	40.00%
Wheatland Oil, Inc.	3.00%
Ray Reid	0.60%

Tract 6: Lots 1, 2, 3, 4, S2N2 of Section 1-161N-95W, 5th PM

Continental Resources, Inc.	28.20%
Headington Oil, LP	25.00%
Amerada Hess Corporation	25.00%
Samson Resources Co.	20.00%
Wheatland Oil, Inc.	1.50%
Ray Reid	0.30%

Tract 7: SW4 of Section 1-161N-95W, 5th PM

Continental Resources, Inc.	56.40%
Samson Resources Co.	40.00%
Wheatland Oil, Inc.	3.00%
Ray Reid	0.60%

Tract 8: SE4 of Section 1-161N-95W, 5th PM

Continental Resources, Inc.	56.40%
Samson Resources Co.	40.00%
Wheatland Oil, Inc.	3.00%
Ray Reid	0.60%

INDUSTRIAL COMMISSION
STATE OF NORTH DAKOTA
DATE 05-25-06 CASE NO. 8986, 8987, 8988, 8990, 8991
Introduced By CRF
Exhibit L-28
Identified By CANNON

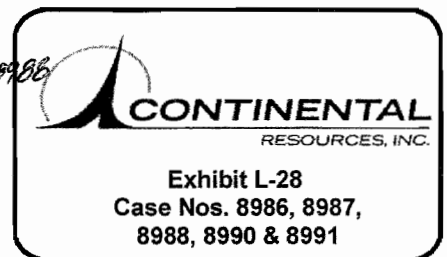

GEOLOGY
EXHIBITS

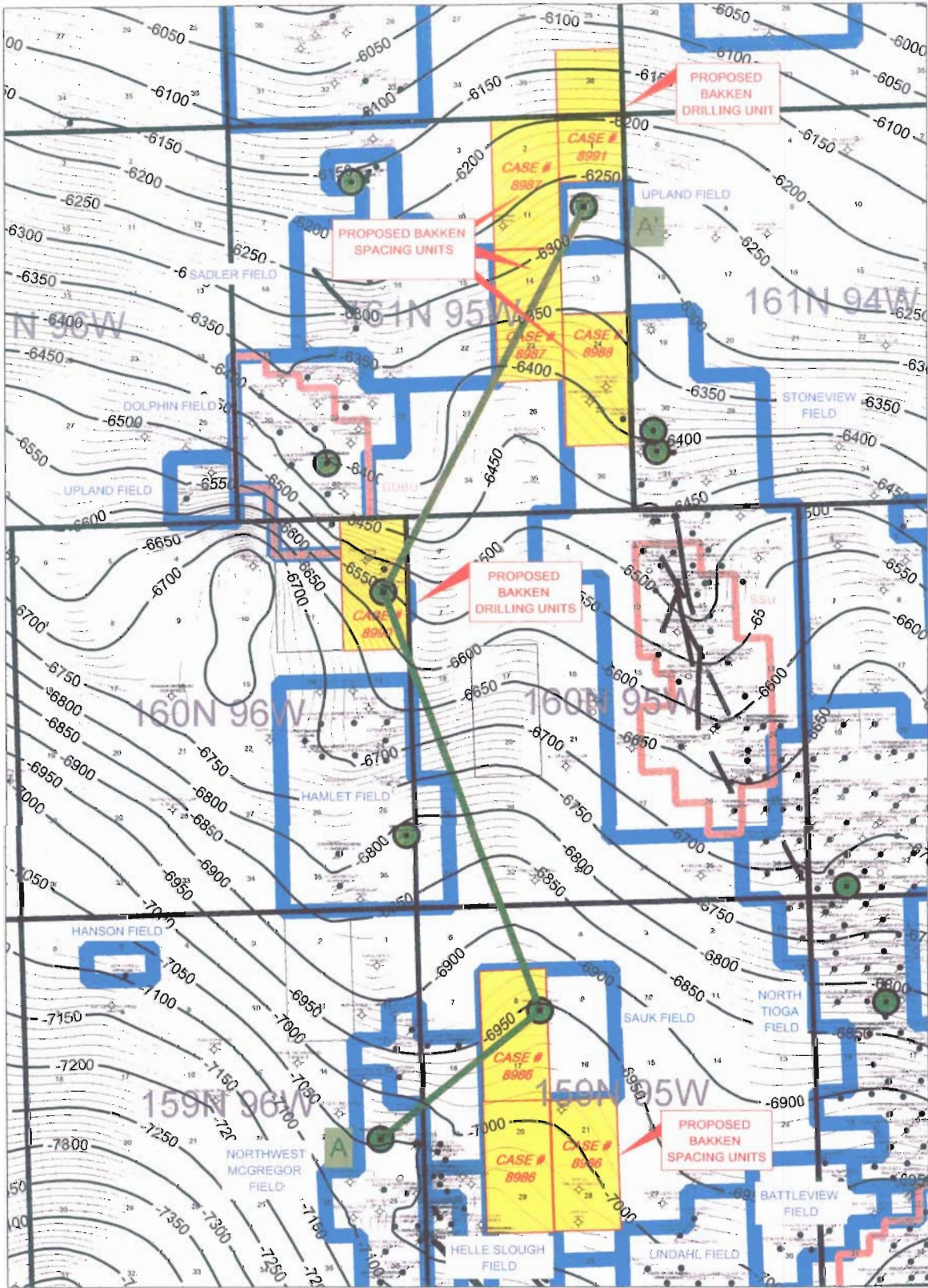

BAKKEN PRODUCER
 INDUSTRIAL COMMISSION
 STATE OF NORTH DAKOTA

DATE 05-25-06 CASE NO. 8986, 8987, 8988, 8990, 8991

Introduced By CRI

Exhibit G-1

Identified By Neil Olesen

	EXPLORATION DEPARTMENT
<p align="center">BAKKEN STRUCTURE MAP Divide County & Williams County, ND CI = 10 FT Case # 8986, 8987, 8988, 8990 & 8991 Exhibit # G-1</p>	
Date: 22 May, 2006	Geologist: Neil Olesen <small>File: nlp ndlc 727.norse.gwp</small>

TYPE CROSS SECTION

<p>33105012430000 BERCO RESOURCES LIMI MCCOY #22-24 22 W2 SE NW TWP: 159N - Range: 96 W - Sec. 24 Field: TEMPLE Cum Gas All Zones: 38489 MCF Cum Oil All Zones: 28890 bbls Cum Water All Zones: 9707 bbls</p>	<p>33105009720000 GALAXY OIL COMPANY TOFTNESS #9-8-9 C NE SE TWP: 159N - Range: 95 W - Sec. 8 Field: SAUK Cum Gas All Zones: 97088 MCF Cum Oil All Zones: 123614 bbls Cum Water All Zones: 19553 bbls</p>	<p>33023002440000 CONDOR PETROLEUM INC TANGSRUD #12-1 1 C NW NE TWP: 180N - Range: 96 W - Sec. 12 Field: HAYLAND Cum Gas All Zones: 80058 MCF Cum Oil All Zones: 134172 bbls Cum Water All Zones: 500133 bbls</p>	<p>33023001740000 KELDON OIL COMPANY ZIMMERMAN #1 1 C SE NW TWP: 161N - Range: 95 W - Sec. 12 Field: BORDER Cum Gas All Zones: 632 MCF Cum Oil All Zones: 578 bbls Cum Water All Zones: 551 bbls</p>
---	---	---	--

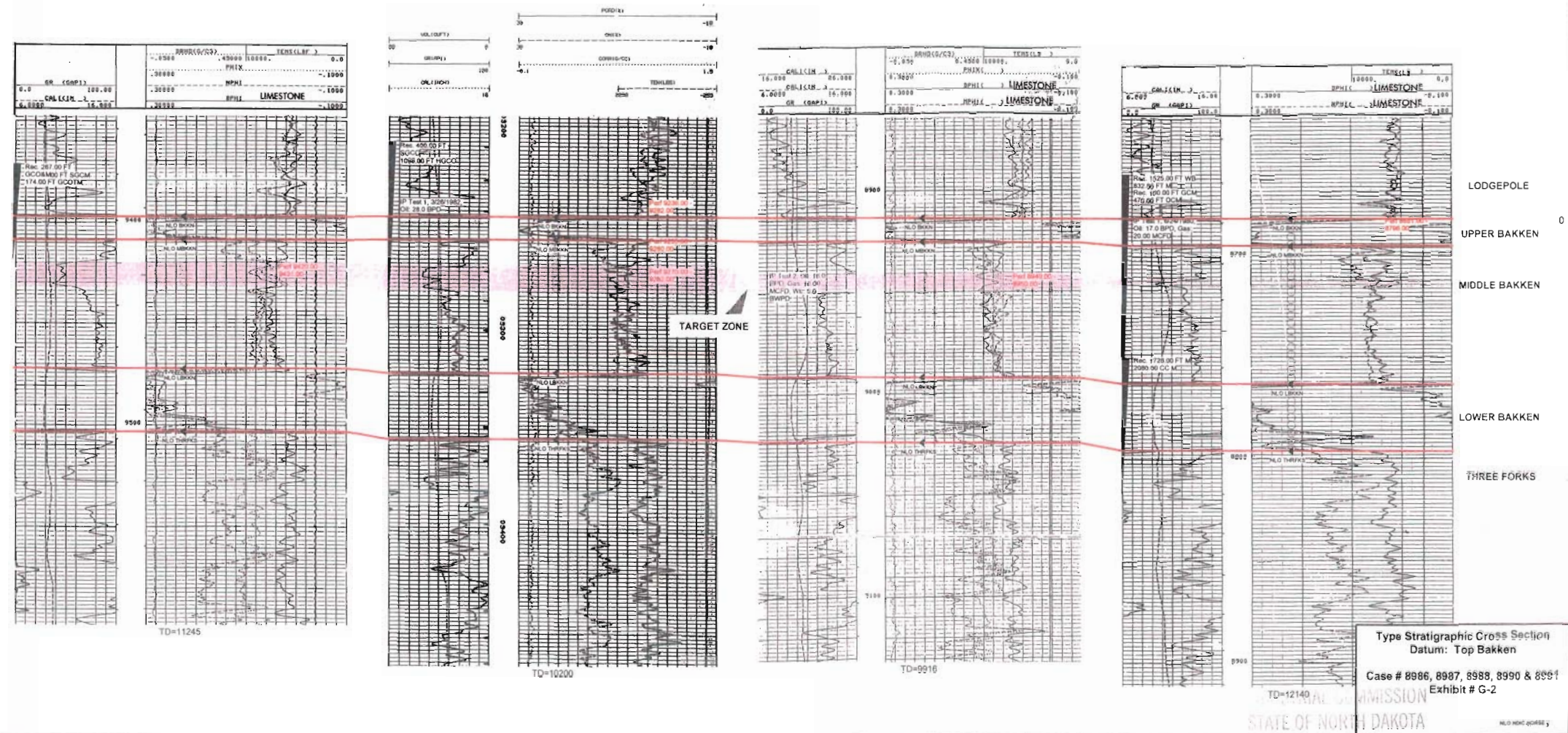

Type Stratigraphic Cross Section
Datum: Top Bakken
Case # 8886, 8987, 8988, 8990 & 8991
Exhibit # G-2

STATE OF NORTH DAKOTA
DATE 05-25-06 CASE NO. 8486, 8487, 8488, 8490, 8491
Introduced By CRI
Exhibit G-2
Identified By Acord

ENGINEERING
EXHIBITS

Continental Resources, Inc.

Typical Horizontal Well 1280 Acre Spacing

RESERVES BASIS

CRI's expectation for North Dakota Bakken reserves is based on Analogy to the Montana Bakken (MB) as follows:

75% of MB results and adjusted for GOR

Reservoir	Bakken	
Initial Rate	300	BOPD
Final rate	3	BOPD
Decline Rate	85	%
Exponent	1.5	
GOR	650	SCF/BBL

ECONOMICS

Oil Price	49	\$/bbl
Gas Price	7	\$/mcf
Operating Cost	4,000	\$/month
Working Interest	100	%
Revenue Interest	80	%
EUR Oil	362	MBO
EUR Gas	235	MMCF
PV@10%	3,560	M\$
<i>INTERNAL</i> ROR@10%	42	%
Payout	2	Years

INDUSTRIAL COMMISSION

STATE OF NORTH DAKOTA

DATE 05-25-06 CASE NO. 8986, 8987, 8988
8990, 8991

Introduced By CRI

Exhibit E-1

Identified By JAMES CARLSON *(GENE CARLSON)*

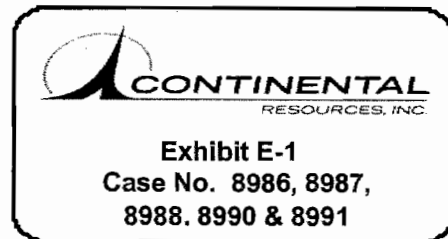

Continental Resources, Inc Dual Lateral "coplanar" Wellbore Schematic

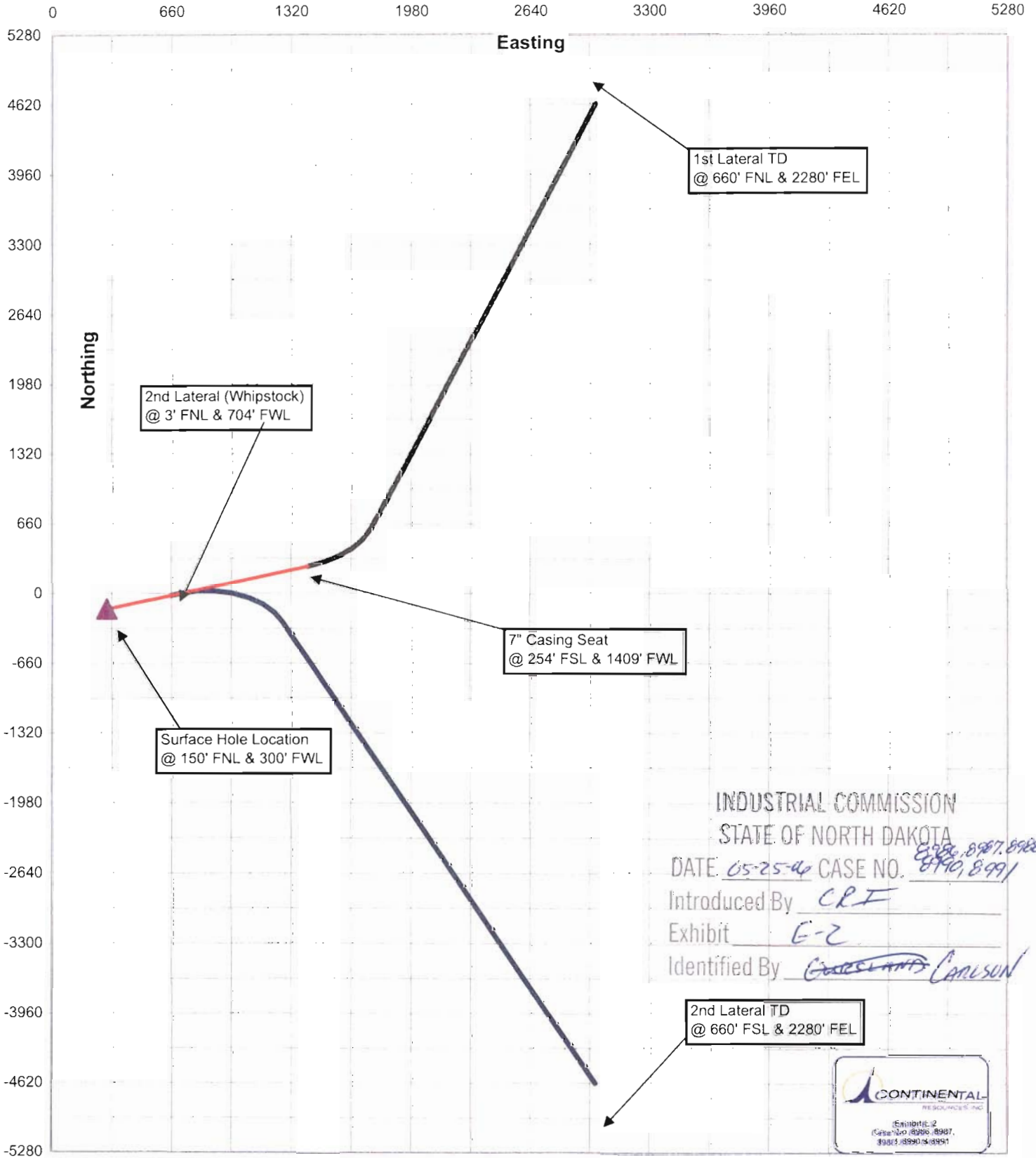

1st Lateral TD
@ 660' FNL & 2280' FEL

2nd Lateral (Whipstock)
@ 3' FNL & 704' FWL

7" Casing Seat
@ 254' FSL & 1409' FWL

Surface Hole Location
@ 150' FNL & 300' FWL

INDUSTRIAL COMMISSION
STATE OF NORTH DAKOTA
DATE: 05-25-04 CASE NO. 8990, 8991
Introduced By CRF
Exhibit E-2
Identified By CAROLAN CARLSON

2nd Lateral TD
@ 660' FSL & 2280' FEL



— First Lateral — Second Lateral ▲ Surface Hole Location — 7" Cased Section



WILLIAM P. PEARCE
PATRICK W. DURICK
B. TIMOTHY DURICK
GARY R. THUNE
DAVID E. REICH
JEROME C. KETTLESON
LARRY L. BOSCHEE ••
LAWRENCE BENDER, PC •
JONATHAN P. SANSTEAD
TIFFANY L. JOHNSON

ATTORNEYS AT LAW
314 EAST THAYER AVENUE
P.O. BOX 400
BISMARCK, NORTH DAKOTA 58502

TELEPHONE (701) 223-2890
FAX (701) 223-7865
E-MAIL: law.office@pearce-durick.com

May 3, 2006

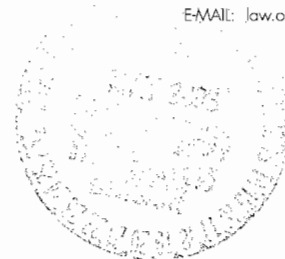

Mr. Bruce Hicks
Assistant Director
North Dakota Industrial Commission
Oil and Gas Division
600 East Boulevard
Bismarck, North Dakota 58505-0310

RE: **NDIC CASE NO. 8987**
APPLICATION OF
CONTINENTAL RESOURCES,
INC.

Dear Mr. Hicks:

Please find enclosed herewith for filing an AFFIDAVIT OF SERVICE BY MAIL.

Should you have any questions, please advise.

Sincerely,

LAWRENCE BENDER

LB/leo

Enclosure

cc: Ms. Karlene Fine - (w/enc.)
Mr. Lynn Helms - (w/enc.)
Mr. Jim Canon - (w/enc.)

BEFORE THE INDUSTRIAL COMMISSION
OF THE STATE OF NORTH DAKOTA

Case No. 8987

In the matter of the application of Continental Resources, Inc. for an order of the Commission extending the field boundaries and amending the field rules for the Sadler-Bakken pool so as to create and establish two 1280-acre spacing units comprised of all of Sections 2 and 11 and Sections 14 and 23, Township 161 North, Range 95 West, Divide County, North Dakota, authorizing the drilling of one horizontal well on each spacing unit, and/or such other and further relief as the Commission deems appropriate.



AFFIDAVIT OF SERVICE BY MAIL

STATE OF NORTH DAKOTA)
) ss.
COUNTY OF BURLEIGH)

Lyn Odden, being first duly sworn, deposes and says that on the 3rd day of May, 2006, she served the attached:

APPLICATION OF CONTINENTAL RESOURCES, INC.

by placing a true and correct copy thereof in an envelope addressed as follows:

See Attached Exhibit A

and depositing the same, with postage prepaid, in the United States mail at Bismarck, North Dakota.

Lyn Odden

LYN ODDEN

Subscribed and sworn to before me this 3rd day of May, 2006.

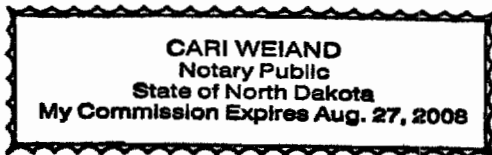

Cari Weiland

Notary Public
Burleigh County, North Dakota
My Commission expires: 8-27-08

A. Rowe III, Inc.
P.O. Box 1815
Texarkana, TX 75504

AA Minerals LLC
410 17th St. #1150
Denver, CO 80202

AgriBank, FCB
P.O. Box 64949
St. Paul, MN 55164-0949

Myrna Allen
23872 Calle Hogar
Mission Viejo, CA 92691

E. Taylor Armstrong, Trustee
4600 1st Interstate Bank Tower
1445 Ross Ave.
Dallas, TX 75202

B and J Resources LLC
410 17th Street, Suite 1150
Denver, CO 80202

Mervin Bennett
P.O. Box 39
Okmulgee, OK 74447

Mrs. Genie H. Bentley
4224 Caruth Blvd.
Dallas, TX 75225

Black Stone Minerals Company, LP
1001 Fannin, Suite 2020
Houston, TX 77002

Elizabeth Mayer Boeckman
5380 Nakoma Dr.
Dallas, TX 75209-5620

Rebecca Jane Bowen
149 Sunningdale Dr.
Winder, GA 30680

Blair Bratlien
1109 8th Ave.
Helena, MT 59601

Dan Bratlien
P.O. Box 21
Tioga, ND 58852

Dennis Bratlien
9641 93rd Ave. NW
Columbus, ND 58727

Jerry Bratlien
4850 Arrowhead Rd.
Helena, MT 59602-8928

Leonard Bratlien
10360 92nd St. NW
Noonan, ND 58765

Paul J. Bratlien
P.O. Box 4242
Helena, MT 59601

Steve Bratlien
220 River St.
Tioga, ND 58852

Jean H. Brown
c/o Northland Royalty
P.O. Box 1676
Bismarck, ND 58502

Idella M. and Gordon L. Burau
9941 County Road 6
Columbus, ND 58727

Roger G. Burau
6704 Blackberry Rd.
Edmund, OK 73034

Thomas F. Burau
RR 1, Box 239
Columbus, ND 58727

R.A. Campbell Trust dated 2/24/93
P.O. Box 577
Story, WY 82842

Eugene E. Carlson
P.O. Box 184
Makoti, ND 58756

Marlys Carlson
9540 County Road L.
Columbus, ND 58727

Alice Dihle
9774 Highway 5
Columbus, ND 58727

Joel Keith Dihle
Rt. 11359 N. 2300th Rd.
Good Hope, IL 61438

Gunhild Dihle
305 County Rd. 5
Columbus, ND 58727

Arlene Easton
715 9th Street NW
Willmar, MN 56201

Alfred E. Ellison, Jr.
3610 Scenic Drive SE
Auburn, WA 98092

EXHIBIT A

Dale L. Ellison
P.O. Box 83, 49 4th Ave. NW
Garrison, ND 58540

Engvold G. Ellison
1308 Spring St.
Helena, MT 59602

James T. Ellison
18691 Mapleoak Lane
Aloha, OR 97006

Robert P. Ellison
9270 104th NW
Noonan, ND 58765

Jill S. Everson
3433 Lynn Ave.
Billings, MT 59102

Alsie Mae Fizer
1626 NE 50th St.
Oklahoma City, OK 73111-6804

Catherine Foster
1104 8th Ave. NE
Watertown, SD 57201-1915

Linda L. Gelvin
4432 San Carlos
Dallas, TX 75205

Gilberston Partnership, Ltd.
7702 N. Via De Fonda
Scottsdale, AZ 85258-3089

Leonard and Ina Mae Gilbertson
905 3rd Ave. NW
Minot, ND 58703

Brent Goldal
113 N. Stanford Ave., #15
Fullerton, CA 92631

Denise Goldal
2717 Pheasant Run Parkway
Williston, ND 58801

Glenda Hawkinson
17365 Oxbridge Rd.
Monument, CO 80132-7908

J. Lanham Higginbotham, Jr. Trust
P.O. Box 720579
Dallas, TX 75372-0579

J. Lanham Higginbotham, III
4204 Purdue Ave.
Dallas, TX 75225-6703

Victoria Johnston, individually and
as
Trustee for John G. Eidell, Jr.
121 Spruce St.
San Francisco, CA 94118

Tim J. and Peggy E. Keating
P.O. Box 20513
Billings, MT 59104

Dick Keller
P.O. Box 1676
Bismarck, ND 58502

William Kiesel, Jr.
2355 Drusilla Ln.
Baton Rouge, LA 70809-1443

Debra Gay Kirchoffner
P.O. Box 1771
Kingston, WA 98346

Bernard Lordemann
826 12th Ave.
Helena, MT 59601-3766

David Lordemann
P.O. Box 391290
Mountain View, CA 94039-1290

Charyl W. and Margaret A.
Loveridge
710 Vandehei Ave.
Cheyenne, WY 82009-2553

Lynch Resources, Ltd.
1845 Woodall Rodgers Frwy.
Lock Box 16
Dallas, TX 75205

Pamela L. McGillis
1000 Ellington Lane
Pasadena, CA 91105

Wyman Orlin Meigs
2408 Zion Park
Yukon, OK 73099

Gene Melgaard Revocable
Living Trust dated January 23, 1996
9375 103rd Avenue NW
Noonan, ND 58765-9522

Susan Melgaard Revocable
Living Trust dated January 23, 1996
9375 103rd Ave. NW
Noonan, ND 58765-9522

Karin Bratlien Moore
P.O. Box 188
Arnold, NE 69120

Murex Petroleum Corporation
P. O. Box 440758
Aurora, CO 80044

Sharon L. Oien
P.O. Box 356
Seabeck, WA 98380

Onnhi, Inc.
P.O. Box 451
Crosby, ND 58730

Norma C. Pederson Revocable Trust
4319 Jackrabbit Drive
Billings, MT 59106

Gary J. Pederson
4319 Jackrabbit Drive
Billings, MT 59106

James O. Pederson
20650 NE Holshey St., #R268
Fairview, OR 97024

Kelly D. Pederson
525 Box Elder St.
Plentywood, MT 59254

Randy C. Pederson
P.O. Box 375
Eugene, OR 97440

Linda J. Rayes, f/k/a
Mrs. Linda J. Latham
4212 Lomo Alto, No. 101-A
Dallas, TX 75219

Reite Revocable Trust
9831 Skycrest Drive
Boise, ID 83704

Ray L. Roberts Trust
4020 Windsor Lane SW
Rochester, MN 55902-1515

Auby Rowe, Jr.
P.O. Box 705
Magnolia, AR 71753-0705

Tyler Allen Rowe
2713 Ash Creek
Mesquite, TX 75181-4213

Judith Salvas
46 Sundance Tr.
Bozeman, MT 59718

Gary Schroeder
HC 1, Box 4
McGregor, ND 58755

Gaylen Schroeder
1317 East Hillcourt
Williston, ND 58801

Mrs. Cynthia Scofield
1610 Potomac Dr.
Houston, TX 77057-1928

Jack Starkweather Trust dated
2/24/93
3054 Forsythia Blvd.
Billings, MT 59102

R.G. Storey and Sons
200 Crescent Court, Suite 1500
Dallas, TX 75201

Sharon Tregidga
1697 Brady
Helena, MT 59601

David E. Turner
23424 127th Ave. SE
Kent, WA 98031

Shirley D. Turner
2707 Clare Ave., Apt. 326
Bremerton, WA 98310

Donna Warner
901 Elm
Helena, MT 59601-0736

Francis Spivy Weber
1200 Catalina Ave., Apt. #406
Redondo Beach, CA 90277

Winston O. Wilson
803 N. Washington St.
Magnolia, AR 71753-2433

Patricia Zanto
5495 Majave Court
Helena, MT 59602

Samson Resources Co.
2 West 2nd St.
Tulsa, OK 74103

Ray Reid
2435 E. Southlake Blvd., #120
Southlake, TX 76092

The Triple T, Inc.
4949 Triple T Rd.
Stanley, ND 58784

Mammoth Exploration, LLC
845 - 12th St. W.
Billings, MT 59102

Headington Oil, LP
7557 Rambler Rd., #1100
Dallas, TX 75231-2320

AgriBank, FCB
P.O. Box 64949
St. Paul, MN 55164-0949

Sig Brodal, as Trustee under
Trust Agreement dated 8-4-87
10112 County Rd. 6
Columbus, ND 58727

James Brodal
9377 101st Ave. NW
Columbus, ND 58727

Lynn Brodal
10131 County Rd. 6
Columbus, ND 58727

Joan Clemens
1301 4th Ave.
Seward, AK 99664

Charlotte Brodal Coleman
10112 County Rd. 6
Columbus, ND 58727

Edith Spooner Fagerbakke
10365 96th St. NW
Noonan, ND 58765

Myrtle J. Forrest
5111 Tara Ave.
Las Vegas, NV 89146

Conrad Larson
10910 - 97th St. NW
Noonan, ND 58765

Karen Larson
10910 - 97th St. NW
Noonan, ND 58765

Linda Lumsden
4801 Fair Hills Road West
Minneapolis, MN 55345

Claire G. Melby
1696 Springhaven Ave.
Newbury Park, CA 91320

Keith S. Melby
1696 Springhaven Ave.
Newbury Park, CA 91320

Gene Melgaard Revocable Living
Trust dated January 23, 1996
9375 103rd Avenue NW
Noonan, ND 58765-9522

Susan Melgaard Revocable Living
Trust dated January 23, 1996
9375 103rd Avenue NW
Noonan, ND 58765-9522

Gina Paul
4000 S. 56th, #259C
Lincoln, NE 68506

Kevin Paul
1581 NW 101st St.
Clive, IA 50325

Arlene Rossow
2903 Vancouver Lane
Bismarck, ND 58503

Alan Spooner
1701 - 69th St. NW
Minot, ND 58701

Glen Spooner
1950 E. 24th St., #96
Yuma, AZ 85365

Neale Spooner
4805 Braeburn Dr.
Las Vegas, NV 89130

Lenore Brodal Tooke
1641 Pinewood Dr.
Clearwater, FL 34616

Gordon J. Wallin and Thelma
A. Wallin Revocable Trust
1950 E. 24th St., #85
Yuma, AZ 85365-3150

Eunice Wenzel
277 Ridge Road
North Aurora, IL 60542

Mammoth Exploration, LLC
845 12th St. W.
Billings, MT 59102

Samson Resources, Co.
2 West 2nd St.
Tulsa, OK 74103

Ray Reid
2435 E. Southlake Blvd., #120
Southlake, TX 76092



WILLIAM P. PEARCE
PATRICK W. DURICK
B. TIMOTHY DURICK
GARY R. THUNE
DAVID E. REICH
JEROME C. KETTLESON
LARRY L. BOSCHEE ♦♦
LAWRENCE BENDER, P.C. ♦
JONATHAN P. SANSTEAD
TIFFANY L. JOHNSON

ATTORNEYS AT LAW
314 EAST THAYER AVENUE
P.O. BOX 400
BISMARCK, NORTH DAKOTA 58502

April 24, 2006

HAND DELIVERED

Mr. Bruce Hicks
Assistant Director
North Dakota Industrial Commission
Oil and Gas Division
600 East Boulevard
Bismarck, North Dakota 58505-0310

**RE: APPLICATION OF
CONTINENTAL RESOURCES,
INC.
Sections 2 and 11 and Sections 14 and
23, Township 161 North, Range 95
West, Divide County, North Dakota**

Dear Mr. Hicks:

Please find enclosed herewith for filing an APPLICATION OF CONTINENTAL RESOURCES, INC. as described above.

As you will note, pursuant to N.D. Admin. Code § 43-02-03-88.2, Continental requests that its witnesses be allowed to participate at the hearing by telephonic means.

Should you have any questions, please advise.

Sincerely,



LAWRENCE BENDER

LB/leo
Enclosure

cc: Ms. Karlene Fine - (w/enc.)
Mr. Lynn Helms - (w/enc.)
Mr. Charles Carvell - (w/enc.)
Mr. Jim Canon - (w/enc.)

BEFORE THE INDUSTRIAL COMMISSION
OF THE STATE OF NORTH DAKOTA



Case No. 8987

In the matter of the application of Continental Resources, Inc. for an order of the Commission extending the field boundaries and amending the field rules for the Sadler-Bakken pool so as to create and establish two 1280-acre spacing units comprised of all of Sections 2 and 11 and Sections 14 and 23, Township 161 North, Range 95 West, Divide County, North Dakota, authorizing the drilling of one horizontal well on each spacing unit, and/or such other and further relief as the Commission deems appropriate.

APPLICATION OF CONTINENTAL RESOURCES, INC.

Applicant, Continental Resources, Inc. ("Continental"), and respectfully states as follows:

1.

That Continental is the owner of an interest in the oil and gas leasehold estate in portions of Sections 2 and 11 and Sections 14 and 23, Township 161 North, Range 95 West, Divide County, North Dakota ("Subject Lands").

2.

That portions of the Subject Lands are within or near the area defined by the North Dakota Industrial Commission ("Commission") as the field boundaries for the Sadler-Bakken Pool.

3.

That pursuant to Commission Order No. 10123 entered in Case No. 8623 dated August 15, 2005, proper spacing in Zone I has been set at one well to 160 acres; in Zone II proper spacing has been set at one horizontal well per 640 acres; and, in Zone III proper spacing has been set at one horizontal well per 1280 acres.

4.

That the Subject Lands are near or within the buffer zone of the Sadler-Bakken Pool.

5.

That Continental desires to utilize the horizontal drilling technique to further develop the Sadler-Bakken Pool underlying the above described property.

6.

That it is the opinion of Continental that use of the horizontal drilling technique to further develop the Sadler-Bakken Pool underlying the above described property will increase the ultimate recovery of the reservoir.

7.

That pursuant to N.D.C.C. §38-08-07 the Commission is empowered to divide any pool into separate zones and to modify its previous spacing order when necessary to prevent waste, avoid the drilling of unnecessary wells or to protect correlative rights.

8.

That in order to prevent waste, to avoid the drilling of unnecessary wells and to protect correlative rights, the field boundaries for the Sadler-Bakken Pool should be extended and two 1280-acre spacing units should be created and established for the Sadler-Bakken Pool comprised of Sections 2 and 11, Township 161 North, Range 95 West, and Sections 14 and 23, Township 161 North, Range 95 West, authorizing the drilling of one horizontal well on each spacing unit.

9.

That Continental, therefore, requests that the Commission extend the field boundaries and amend the field rules for the Sadler-Bakken Pool so as to create and establish two 1280-acre spacing

units comprised of Sections 2 and 11 and Sections 14 and 23, Township 161 North, Range 95 West, Divide County, North Dakota, and authorizing the drilling of a horizontal well on each spacing unit and/or such other and further relief as the Commission deems appropriate.

WHEREFORE, Continental requests the following:

(a) That this matter be set for hearing at the regular May 25, 2006 meeting and thereafter the Commission issue its order granting the relief requested and such other and further relief as the Commission may deem appropriate; and

(b) That pursuant to N.D. Admin. Code § 43-02-03-88.2, Continental's witnesses in this matter be allowed to participate by telephonic means.

DATED this 24 day of April, 2006.

PEARCE & DERRICK

By

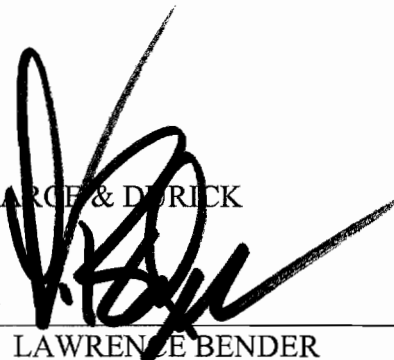

LAWRENCE BENDER
Attorneys for Applicant,
Continental Resources, Inc.
314 E. Thayer Avenue
P. O. Box 400
Bismarck, ND 58502-0400
(701) 223-2890

**NOTICE OF PUBLICATION
NORTH DAKOTA INDUSTRIAL COMMISSION**

BISMARCK, NORTH DAKOTA

The State of North Dakota by its Industrial Commission hereby gives notice pursuant to law and the rules and regulations of said Commission promulgated thereunder of the following public hearing to be held 9:00 a.m. on Thursday, May 25, 2006, North Dakota Oil and Gas Division Office, 1016 East Calgary Avenue, Bismarck, North Dakota. For the purpose of this hearing, the Commission, any member thereof acting as Examiner, or an Examiner appointed by the Commission will receive testimony and exhibits.

ATTENTION PERSONS WITH DISABILITIES: If you plan to attend the hearing and will need special facilities or assistance relating to a disability, please contact the North Dakota Industrial Commission at 701-328-3722 by Friday, May 12, 2006.

STATE OF NORTH DAKOTA TO:

All named parties and persons having any right, title, interest, or claim in the following cases and notices to the public:

Case No. 8987: On a motion of the Commission to consider the application of Continental Resources, Inc. for an order extending the field boundaries and amending the field rules for the Sadler-Bakken Pool so as to create and establish two 1280-acre spacing units comprised of all of Sections 2 and 11 and Sections 14 and 23, T.161N., R.95W., Divide County, North Dakota, authorizing the drilling of one horizontal well on each spacing unit, and/or such other and further relief as the Commission deems appropriate.

Case No. 8988: On a motion of the Commission to consider the application of Continental Resources, Inc. for an order extending the field boundaries and amending the field rules for the Stoneview-Bakken Pool

so as to create and establish a 1280-acre spacing unit comprised of all of Sections 24 and 25, T.161N., R.95W., Divide County, North Dakota, authorizing the drilling of one horizontal well on said spacing unit, and/or such other and further relief as the Commission deems appropriate.

Case No. 8990: On a motion of the Commission to consider the application of Continental Resources, Inc. for an order creating a 1280-acre drilling unit comprised of all of Sections 1 and 12, T.160N., R.96W., Divide County, North Dakota, authorizing the drilling of a horizontal well therein at a location not less than 500 feet from the boundary of the said drilling unit as an exception to the provisions of Section 43-02-03-18 of the North Dakota Administrative Code, and such other and further relief as the Commission deems appropriate.

Case No. 8991: On a motion of the Commission to consider the application of Continental Resources, Inc. for an order creating a 1280-acre drilling unit comprised of all of Section 1, T.161N., R.95W., and Section 36, T.162N., R.95W., Divide County, North Dakota, authorizing the drilling of a horizontal well therein at a location not less than 500 feet from the boundary of the said drilling unit as an exception to the provisions of Section 43-02-03-18 of the North Dakota Administrative Code, and such other and further relief as the Commission deems appropriate.

Signed by,
John Hoeven, Governor
Chairman,
ND Industrial Commission

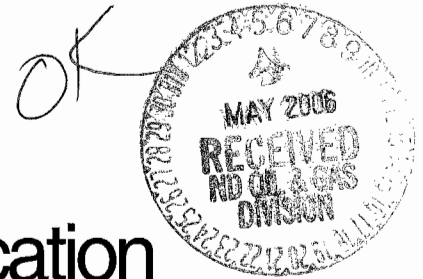

Affidavit of Publication

State of North Dakota, County of Divide, ss:

I, Steven J. Andrist, being first duly sworn, on my oath, say that I am the publisher of The Journal, a weekly newspaper of general circulation and official newspaper of Divide County, State of North Dakota, published in the city of Crosby, ND, and that the advertisement headed

**NOTICE OF PUBLICATION
NORTH DAKOTA INDUSTRIAL COMMISSION**

a printed copy of which is here attached, was published in The Journal on the following dates:

May 3, 2006 99 lines @ .52 = 51.48

TOTAL CHARGE \$51.48

Signed Steven J. Andrist
Steven J. Andrist, Publisher

Subscribed and sworn to before me May 3, 2006

Vonni L. Anderson
Vonni L. Anderson

VONNI L. ANDERSON
Notary Public
State of North Dakota
My Commission Expires Aug. 2, 2011

Notary Public, State of North Dakota
My Commission Expires August 2, 2011

NOTICE OF PUBLICATION
NORTH DAKOTA INDUSTRIAL COMMISSION
BISMARCK, NORTH DAKOTA

The State of North Dakota by its Industrial Commission hereby gives notice pursuant to law and the rules and regulations of said Commission promulgated thereunder of the following public hearing to be held 9:00 a.m. on Thursday, May 25, 2006, North Dakota Oil and Gas Division Office, 1016 East Calgary Avenue, Bismarck, North Dakota. For the purpose of this hearing, the Commission, any member thereof acting as Examiner, or an Examiner appointed by the Commission will receive testimony and exhibits.

ATTENTION PERSONS WITH DISABILITIES: If you plan to attend the hearing and will need special facilities or assistance relating to a disability, please contact the North Dakota Industrial Commission at 701-328-3722 by Friday, May 12, 2006.

STATE OF NORTH DAKOTA TO:

All named parties and persons having any right, title, interest, or claim in the following cases and notices to the public: **Case No. 8979:** On a motion of the Commission to consider the application of **Everton Operating Company, Inc.**, for an order establishing a 1280-acre drilling unit comprised of all of Sections 24 and 25, T.157N., R.97W., Williams County, North Dakota and authorizing the drilling of a horizontal well within said drilling unit at any location not closer than 500 feet to the boundaries thereof, as an exception to Section 43-02-03-18 of the North Dakota Administrative Code, and/or such other and further relief as the Commission may deem appropriate. **Case No. 8980:** On a motion of the Commission to consider the temporary spacing for the development of an oil and/or gas pool discovered by the **Enerplus Resources USA Corporation #20-I-H Titan E. Gierke well**, located in the NE/4 NE/4 of Section 20, T.150N., R.97W., McKenzie County, North Dakota, define the limits of the field, and enact such special field rules as may be necessary. **Case No. 8981:** On a motion of the Commission to consider the application of **Zenergy, Inc.** for an order to establish temporary spacing for the **Zenergy, Inc. Lewis #1-36H well**, located in the NW/4 of the NW/4 of Section 36, Township 152 North, Range 104 West, McKenzie County, North Dakota, define the limits of the field, enact such special field rules as may be necessary and such further and additional relief as the Commission deems appropriate. **Case No. 8982:** On a motion of the Commission to consider the application of **Zenergy, Inc.** for an order pursuant to North Dakota Administrative Code Section 43-02-03-88.1 pooling all interests in a spacing unit described as all of Section 35, T.152N., R.104W., McKenzie County, North Dakota; authorizing the recovery from each nonparticipating owner a risk penalty as provided by North Dakota Century Code Section 38-08-08 and such other and further relief as the Commission deems appropriate. **Case No. 8983:** On a motion of the Commission to consider the application of **Ansbro Petroleum Company, LLC** for an order extending the field boundaries and amending the field rules for the **Fayette-Bakken Pool** so as to create a 1280-acre spacing unit comprised of Sections 34 and 35, T.143N., R.96W., Dunn County, North Dakota, authorizing the drilling of one horizontal well within said spacing unit not less than 500 feet to the boundary of the spacing unit and providing such further and additional relief as the Commission deems appropriate. **Case No. 8984:** On a motion of the Commission to consider the application of **Continental Resources, Inc.** for an order extending the field boundaries and amending the field rules for the **St. Demetrius-Bakken pool** so as to create and establish two 1280-acre spacing units comprised of all of Sections 1 and 12 and Sections 2 and 11, T.141N., R.99W., Billings County, North Dakota, authorizing the drilling of one horizontal well on each spacing unit, and/or such other and further relief as the Commission deems appropriate. **Case No. 8985:** On a motion of the Commission to consider the application of **Continental Resources, Inc.** for an order pursuant to Section 43-02-03-88.1 of the North Dakota Administrative Code pooling all interests in a spacing unit for the **St. Demetrius-Bakken Pool** described as all of Sections 2 and 11, T.142N., R.99W., Billings County, North Dakota; authorizing the recovery from each nonparticipating owner a risk penalty as provided by North Dakota Century Code Section 38-08-08 and such other and further relief as the Commission deems appropriate. **Case No. 8986:** On a motion of the Commission to consider the application of **Continental Resources, Inc.** for an order extending the field boundaries and amending the field rules for the **Sauk-Bakken Pool** so as to create and establish three 1280-acre spacing units comprised of all of Sections 8 and 17, Sections 20 and 29, and Sections 21 and 28, T.159N., R.95W., Williams County, North Dakota, authorizing the drilling of one horizontal well on each spacing unit, and/or such other and further relief as the Commission deems appropriate. **Case No. 8987:** On a motion of the Commission to consider the application of **Continental Resources, Inc.** for an order extending the field boundaries and amending the field rules for the **Sadler-Bakken Pool** so as to create and establish two 1280-acre spacing units comprised of all of Sections 2 and 11 and Sections 14 and 23, T.161N., R.95W., Divide County, North Dakota, authorizing the drilling of one horizontal well on each spacing unit, and/or such other and further relief as the Commission deems appropriate. **Case No. 8988:** On a motion of the Commission to consider the application of **Continental Resources, Inc.** for an order extending the field boundaries and amending the field rules for the **Stoneview-Bakken Pool** so as to create and establish a 1280-acre spacing unit comprised of all of Sections 24 and 25, T.161N., R.95W., Divide County, North Dakota, authorizing the drilling of one horizontal well on said spacing unit, and/or such other and further relief as the Commission deems appropriate. **Case No. 8989:** On a motion of the Commission to consider the application of **Continental Resources, Inc.** for an order creating a 1280-acre drilling unit comprised of all of Sections 17 and 20, T.141N., R.98W., Billings County, North Dakota, authorizing the drilling of a horizontal well therein at a location not less than 500 feet from the boundary of the said drilling unit as an exception to the provisions of Section 43-02-03-18 of the North Dakota Administrative Code, and such other and further relief as the Commission deems appropriate. **Case No. 8990:** On a motion of the Commission to consider the application of **Continental Resources, Inc.** for an order creating a 1280-acre drilling unit comprised of all of Sections 1 and 12, T.160N., R.96W., Divide County, North Dakota, authorizing the drilling of a horizontal well therein at a location not less than 500 feet from the boundary of the said drilling unit as an exception to the provisions of Section 43-02-03-18 of the North Dakota Administrative Code, and such other and further relief as the Commission deems appropriate. **Case No. 8991:** On a motion of the Commission to consider the application of **Continental Resources, Inc.** for an order creating a 1280-acre drilling unit comprised of all of Section 1, T.161N., R.95W., and Section 36, T.162N., R.95W., Divide County, North Dakota, authorizing the drilling of a horizontal well therein at a location not less than 500 feet from the boundary

of the said drilling unit as an exception to the provisions of Section 43-02-03-18 of the North Dakota Administrative Code, and such other and further relief as the Commission deems appropriate. **Case No. 8965:** (Continued) On a motion of the Commission to consider the application of **Continental Resources, Inc.** for an order amending the field rules for the **Medora-Madison Pool** so as to create a 160-acre spacing unit comprised of the NW/4 of Section 30, T.139N., R.101W., Billings County, North Dakota, authorizing the drilling of one horizontal well within said spacing unit not less than 500 feet to the boundary of said spacing unit and providing such further and additional relief as the Commission deems **Case No. 8844:** (Continued) On a motion of the Commission to consider the application of **Upton Resources U.S.A. Inc.** for an order extending the field boundaries and amending the field rules for the **Davis Creek-Madison Pool** so as to create and establish a 1280-acre spacing unit comprised of all of Sections 26 and 27, T.139N., R.100W., Billings County, North Dakota, authorizing the drilling of one horizontal well on said spacing unit, and/or such other and further relief as the Commission deems appropriate. **Case No. 8967:** (Continued) On a motion of the Commission to consider the application of **Prima Exploration, Inc.** for an order creating a 1280-acre drilling unit comprised of all of Sections 23 and 26, T.156N., R.91W., Mountrail County, North Dakota, authorizing the drilling of a horizontal well therein at a location not less than 500 feet from the boundary of the proposed drilling unit as an exception to the provisions of Section 43-02-03-18 of the North Dakota Administrative Code, and such other and further relief as the Commission deems appropriate. **Case No. 8992:** On a motion of the Commission to consider the application of **Petroleum Development Corporation** for an order creating four 1280-acre drilling units consisting of all of Sections 5 and 8, T.146N., R.98W., all of Sections 3 and 10, T.146N., R.99W., all of Sections 2 and 11 and all of Sections 17 and 20, T.147N., R.98W., McKenzie County, North Dakota, and allowing a horizontal well with one or more laterals to be drilled on each such drilling unit at any location not closer than 500 feet to the boundary of the drilling unit, or for such other and further relief as the Commission deems appropriate. **Case No. 8993:** On a motion of the Commission to consider the application of **Petroleum Development Corporation** for an order creating two 1280-acre drilling units consisting of all of Sections 6 and 7, T.155N., R.96W., and all of Sections 25 and 36, T.156N., R.97W., Williams County, North Dakota, and allowing a horizontal well with one or more laterals to be drilled on each such drilling unit at any location not closer than 500 feet to the boundary of the drilling unit, or for such other and further relief as the Commission deems appropriate. **Case No. 8994:** On a motion of the Commission to consider the application of **Whiting Oil and Gas Corporation** for an order pooling all interests in a spacing unit for the **Beaver Creek-Madison Pool** described as the E/2 of Section 31, T.143N., R.102W., Billings County, North Dakota and allowing the recovery of a risk penalty from those owners who elect not to participate in the risk and cost of drilling the **Federal #34-31H well**, or for such other and further relief as the Commission deems appropriate. **Case No. 8995:** On a motion of the Commission to consider the temporary spacing for the development of an oil and/or gas pool discovered by the **Amerada-Hess Corporation #1-IH J. Horst well**, located in the NW/4 NW/4 of Section 11, T.154N., R.93W., Mountrail County, North Dakota, define the limits of the field, and enact such special field rules as may be necessary. **Case No. 8944:** (Continued) On a motion of the Commission to consider the temporary spacing for the development of an oil and/or gas pool discovered by the **Hunt Petroleum (AEC), Inc. #11-3 Jones well**, located in the NW/4 NW/4 of Section 3, T.143N., R.104W., Golden Valley County, North Dakota, define the limits of the field, and enact such special field rules as may be necessary. **Case No. 8958:** (Continued) On a motion of the Commission to consider the temporary spacing for the development of an oil and/or gas pool discovered by the **Dominion Oklahoma Texas Exploration & Production, Inc. #1 O. M. Seel Federal well**, located in the NE/4 SE/4 of Section 32, T.153N., R.103W., Williams County, North Dakota, define the limits of the field, and enact such special field rules as may be necessary. **Case No. 8459:** (Continued) On a motion of the Commission to consider the proper spacing for the development of the **Larson-Red River Pool**, Burke County, North Dakota, redefine the limits of the field, and enact such special field rules as may be necessary. **Jordan Exploration Company, LLC Case No. 8996:** On a motion of the Commission to consider the application of **CamWest II LP** for an order pursuant to North Dakota Administrative Code (NDAC) Section 43-02-03-88.1 allowing oil and gas produced from the **Sullivan #2 well**, located in the SW/4 SW/4, and the **Sullivan #3 well**, located in the SE/4 SW/4, Section 19, T.158N., R.81W., Glenburn Field, Renville County, North Dakota, to be commingled in a central tank battery as an exception to the requirements of NDAC Section 43-02-03-48 pursuant to Section 43-02-03-48.1, or for such other and further relief as the Commission deems **Case No. 8997:** On a motion of the Commission to consider the application of **CamWest II LP** for an order pursuant to North Dakota Administrative Code (NDAC) Section 43-02-03-88.1 allowing oil and gas produced from the **Mildred #1 well**, located in the SW/4 NW/4, and the **Mildred #2 well**, located in the NW/4 NW/4, Section 14, T.158N., R.82W., Glenburn Field, Renville County, North Dakota, to be commingled in a central tank battery as an exception to the requirements of NDAC Section 43-02-03-48 pursuant to Section 43-02-03-48.1, or for such other and further relief as the Commission deems **Case No. 8998:** On a motion of the Commission to consider the application of **CamWest II LP** for an order pursuant to North Dakota Administrative Code (NDAC) Section 43-02-03-88.1 allowing oil and gas produced from the **Earl C. Palmer #1 well**, located in the NE/4 SW/4, and the **Palmer #2-11 well**, located in the SE/4 SW/4, Section 11, T.158N., R.82W., Glenburn Field, Renville County, North Dakota, to be commingled in a central tank battery as an exception to the requirements of NDAC Section 43-02-03-48 pursuant to Section 43-02-03-48.1, or for such other and further relief as the Commission deems **Case No. 8999:** On a motion of the Commission to consider the application of **CamWest II LP** for an order pursuant to North Dakota Administrative Code (NDAC) Section 43-02-03-88.1 allowing oil and gas produced from the **Maercklein #1 well**, located in the SW/4 SE/4, and the **Maercklein #2 well**, located in the SE/4 SE/4, Section 24, T.158N., R.82W., Glenburn Field, Renville County, North Dakota, to be commingled in a central tank battery as an exception to the requirements of NDAC Section 43-02-03-48 pursuant to Section 43-02-03-48.1, or for such other and further relief as the Commission deems

Signed by,
John Hoeven, Governor
Chairman, ND Industrial Commission
5/2 - 600107

et Amt Due

236.64

236.64